

2004 GENERAL MOTORS

Corvette

BUZZERS, RELAYS & TIMERS

BUZZERS, RELAYS & TIMERS LOCATION

Component	Location
A/C CLU Relay	In underhood fuse block. See Fig. 20 .
AIR PMP Relay	In underhood fuse block. See Fig. 20 .
ALC HDLP Relay	In instrument panel fuse block. See Fig. 19 .
ALC PRK LP Relay	In instrument panel fuse block. See Fig. 19 .
BACKUP LP Relay	In underhood fuse block. See Fig. 20 .
Blower Motor Relay	On multi-use relay & fuse bracket, above BCM. See Fig. 8 .
BOSE Relay	In instrument panel fuse block. See Fig. 19 .
COOLFAN1 Relay	In underhood fuse block. See Fig. 20 .
COOLFAN2 Relay	In underhood fuse block. See Fig. 20 .
COOLFAN3 Relay	In underhood fuse block. See Fig. 20 .
CTSY LP Relay	In instrument panel fuse block. See Fig. 19 .
DRL L Relay	In instrument panel fuse block. See Fig. 19 .
DRL R Relay	In instrument panel fuse block. See Fig. 19 .
FOG LP Relay	In underhood fuse block. See Fig. 20 .
F/PMP Relay	In underhood fuse block. See Fig. 20 .
HTCHTRK REL Relay	In instrument panel fuse block. See Fig. 19 .
HORN Relay	In underhood fuse block. See Fig. 20 .
IGN Relay	In underhood fuse block. See Fig. 20 .
Monitored LD Relay	In instrument panel fuse block. See Fig. 19 .
RRFOGLP Relay	In underhood fuse block. See Fig. 20 .
Seat Relay Center (Driver)	Under driver seat. See Fig. 54 .
Seat Relay Center (Passenger)	Under passenger seat. See Fig. 54 .
Steering Column Lock Relay	In right footwell, mounted to toe board. See Fig. 8 .
Theft Deterrent Relay	In right footwell, above BCM. See Fig. 8 .
TONN REL Relay	In instrument panel fuse block. See Fig. 19 .

CIRCUIT PROTECTION DEVICES

CIRCUIT PROTECTION DEVICES LOCATION

Component	Location
I/P Fuse Block	In right front footwell, mounted to toe board. See Fig. 6 .
Underhood Fuse Block	On right side of engine compartment. See Fig. 1 .

CONTROL UNITS

CONTROL UNITS LOCATION

Component	Location
Blower Motor Control Processor	Behind right side of dash. See Fig. 6 .
Body Control Module (BCM)	Mounted on toe board, in right footwell. See Fig. 6 .
BOSE Signal Processor	Under left side of dash, above accelerator pedal. See Fig. 9 .
Driver Door Module (DDM)	In lower center of respective door. See Fig. 49 .
Electronic Brake Control Module (EBCM)	At left front side of engine compartment, on frame rail. See Fig. 18 .
Electronic Suspension Control (ESC) Module	In rear compartment, inside left storage compartment. See Fig. 24 .
HVAC Module Assembly	Center of dash, under radio. See Fig. 6 .
Ignition Coil/Module	On valve cover, top of respective cylinder. See Fig. 13 .
Ignition Coil/Module 1	On valve cover, top of respective cylinder. See Fig. 13 .
Ignition Coil/Module 2	On valve cover, top of respective cylinder. See Fig. 13 .
Ignition Coil/Module 3	On valve cover, top of respective cylinder. See Fig. 12 .
Ignition Coil/Module 4	On valve cover, top of respective cylinder. See Fig. 13 .
Ignition Coil/Module 5	On valve cover, top of respective cylinder. See Fig. 12 .
Ignition Coil/Module 6	On valve cover, top of respective cylinder. See Fig. 13 .
Ignition Coil/Module 7	On valve cover, top of respective cylinder. See Fig. 12 .
Ignition Coil/Module 8	On valve cover, top of respective cylinder. See Fig. 13 .
Inflatable Restraint IP Module	At right side of dash. See Fig. 43 .
Inflatable Restraint Sensing & Diagnostic Module (SDM)	Below center of dash, under HVAC control head. See Fig. 43 .
Inflatable Restraint Steering Wheel Module	Top of steering wheel. See Fig. 43 .
Inflatable Restraint Steering Wheel Module Coil	Top of steering column. See Fig. 43 .
Passenger Door Module	Bottom center of door, rear of speaker. See Fig. 49 .
Powertrain Control Module (PCM)	Behind right front fender, between wheelhouse & dash panel. See Fig. 31 .
Radio Antenna Module (Coupe)	Behind lower "B" pillar trim panel. See Fig. 10 .
Remote Control Door Lock Receiver (RCDLR)	On left side of rear compartment. See Fig. 45 .
Seat Control Module (SCM) (Driver)	Under driver seat. See Fig. 54 .
Seat Control Module (SCM) (Passenger)	Under passenger seat. See Fig. 54 .
Throttle Actuator Control (TAC) Module	On PCM, below battery. See Fig. 31 .
Vacuum Control Assembly	On right side of HVAC unit, right of blower motor. See Fig. 6 .

MOTORS

MOTORS LOCATION

Component	Location
Air Temperature Actuator (Left)	On left side of HVAC module assembly. See Fig. 22 .
Air Temperature Actuator (Right)	On right side of HVAC module assembly. See Fig. 22 .
Blower Motor	Under right side of dash. See Fig. 6 .
Cooling Fan (Left)	Behind left side of radiator. See Fig. 27 .
Cooling Fan (Right)	Behind right side of radiator. See Fig. 27 .
Door Latch (Driver)	In rear of door. See Fig. 49 .
Door Latch (Passenger)	In rear of door. See Fig. 49 .
Folding Top Actuator	Part of folding top lid latch. See Fig. 46 .
Folding Top Lid Latch	Attached to stowage lid extension panel bracket. See Fig. 46 .
Fuel Door Lock Actuator	On left side of cargo compartment, above fuel filler door. See Fig. 47 .
Fuel Pump & Sender Assembly	In left fuel tank. See Fig. 32 .
Headlamp Door Assembly (Left)	Behind left headlamp. See Fig. 61 .
Headlamp Door Assembly (Right)	Behind right headlamp. See Fig. 61 .
Rear Compartment Lid Latch (Convertible/Hardtop)	On center rear of rear compartment, on latch. See Fig. 24 .
Rear Compartment Lid Latch (Left) (Coupe)	On left rear of rear compartment, on latch. See Fig. 48 .
Rear Compartment Lid Latch (Right) (Coupe)	On right rear of rear compartment, on latch. See Fig. 48 .
Seat Lower Motor (Driver)	Under driver seat. See Fig. 54 .
Seat Lower Motor (Passenger)	Under passenger seat. See Fig. 54 .
Seat Pump Connector (Driver)	Under driver seat. See Fig. 54 .
Seat Pump Connector (Passenger)	Under passenger seat. See Fig. 54 .
Seat Pump (Driver)	Under driver seat. See Fig. 54 .
Seat Pump (Passenger)	Under passenger seat. See Fig. 54 .
Secondary Air Injection (AIR) Pump Motor	On left front of engine compartment, on skid bar. See Fig. 17 .
Starter	Right side of engine. See Fig. 29 .
Telescoping Drive Motor	On lower right side of steering column. See Fig. 7 .
Throttle Actuator Control (TAC) Motor	On left side of throttle body. See Fig. 13 .
Variable Effort Steering Actuator	On left side of steering rack assembly. See Fig. 62 .
Variable Effort Steering Actuator Connector	On left side of steering rack assembly. See Fig. 62 .
Window Motor (Driver)	Lower section of door. See Fig. 49 .
Window Motor (Passenger)	Lower section of door. See Fig. 49 .
Windshield Washer Fluid Pump	On left rear of engine compartment, in washer fluid reservoir. See Fig. 56 .
Windshield Washer Fluid Pump Connector	On left rear of engine compartment, on washer fluid reservoir. See Fig. 56 .

SENDING UNITS & SENSORS

SENDING UNITS & SENSORS LOCATION

Component	Location
Accelerator Pedal Position (APP) Sensor	On top of accelerator pedal, part of mounting bracket. See Fig. 9 .
A/C Refrigerant Pressure Sensor	On A/C high pressure line. See Fig. 17 .
Air Temperature Sensor (Inside)	Right of steering column, in air outlet vent. See Fig. 6 .
Ambient Air Temperature Sensor	On radiator support, at right front of engine. See Fig. 23 .
Ambient Light Sensor	On top left side of dash, under defroster grille. See Fig. 6 .
Brake Fluid Pressure Sensor	On left side of brake pressure modulator valve. See Fig. 25 .
Camshaft Position (CMP) Sensor	On top center rear of engine. See Fig. 16 .
Crankshaft Position (CKP) Sensor	On lower right side of engine, behind starter. See Fig. 35 .
Engine Coolant Temperature (ECT) Sensor	On left side of engine, below generator. See Fig. 13 .
Engine Oil Pressure (EOP) Sensor	On top center rear of engine. See Fig. 16 .
Engine Oil Temperature (EOT) Sensor	On bottom left rear of engine. See Fig. 13 .
Fuel Level Sensor (Right)	In right fuel tank. See Fig. 32 .
Fuel Tank Pressure Sensor	In right fuel tank. See Fig. 32 .
Heated Oxygen Sensor (HO2S), Bank 1 Sensor 1	On left exhaust manifold. See Fig. 15 .
Heated Oxygen Sensor (HO2S), Bank 1 Sensor 2	In exhaust system, rearward of catalytic converter. See Fig. 36 .
Heated Oxygen Sensor (HO2S), Bank 2 Sensor 1	In right exhaust manifold. See Fig. 35 .
Heated Oxygen Sensor (HO2S), Bank 2 Sensor 2	In exhaust system, rearward of catalytic converter. See Fig. 36 .
Knock Sensor (KS) 1	On center of engine, below intake manifold. See Fig. 30 .
Knock Sensor (KS) 2	On center of engine, below intake manifold. See Fig. 30 .
Lateral Accelerometer Sensor	Under right seat. See Fig. 25 .
Manifold Absolute Pressure (MAP) Sensor	On top rear of intake manifold. See Fig. 16 .
Mass Airflow (MAF) Sensor	On air intake assembly. See Fig. 28 .
Steering Wheel Position Sensor	At base of steering column. See Fig. 7 .
Sunload Sensor	On top of dash, right side of defroster grille. See Fig. 6 .
Suspension Position Sensor (Left Front)	Left front suspension control arm. See Fig. 58 .
Suspension Position Sensor (Left Rear)	Left rear suspension control arm. See Fig. 58 .
Suspension Position Sensor (Right Front)	Right front suspension control arm. See Fig. 58 .
Suspension Position Sensor (Right Rear)	Right rear suspension control arm. See Fig. 58 .
Telescoping Sensor	On lower right side of steering column. See Fig. 7 .
Throttle Position (TP) Sensor	On right side of throttle body assembly. See Fig. 13 .

Tire Pressure Monitor Sensor (4)	Inside each respective wheel, part of valve stem. See Fig. 57 .
Transmission Fluid Temperature (TFT) Sensor	Left side of transmission. See Fig. 37 .
Vehicle Speed Sensor (VSS) (M/T)	On right side of differential. See Fig. 34 .
Vehicle Speed Sensor (VSS) (A/T)	On top right of differential. See Fig. 41 .
Wheel Speed Sensor (WSS) (Left Front)	Left front wheel. See Fig. 26 .
Wheel Speed Sensor (WSS) (Left Rear)	Left rear wheel. See Fig. 26 .
Wheel Speed Sensor (WSS) (Right Front)	Right front wheel. See Fig. 26 .
Wheel Speed Sensor (WSS) (Right Rear)	Right rear wheel. See Fig. 26 .
Yaw Rate Sensor	Under HVAC control head. See Fig. 25 .

SOLENOIDS & SOLENOID VALVES

SOLENOIDS & SOLENOID VALVES LOCATION

Component	Location
A/C Compressor Clutch	Right front of engine block. See Fig. 21 .
A/T Shift Lock Control Solenoid	Under center console, part of shifter. See Fig. 38 .
Brake Pressure Modulator Valve (BPMV)	Left side of engine compartment, near power steering pump. See Fig. 18 .
Evaporative Emission (EVAP) Canister Purge Valve	On top left side of engine, on intake manifold. See Fig. 13 .
Evaporative Emission (EVAP) Canister Vent Solenoid	Inside right rear wheelhouse panel. See Fig. 33 .
Fuel Injector 1	Top of engine, below fuel rail. See Fig. 13 .
Fuel Injector 2	Top of engine, below fuel rail. See Fig. 13 .
Fuel Injector 3	Top of engine, below fuel rail. See Fig. 12 .
Fuel Injector 4	Top of engine, below fuel rail. See Fig. 13 .
Fuel Injector 5	Top of engine, below fuel rail. See Fig. 12 .
Fuel Injector 6	Top of engine, below fuel rail. See Fig. 12 .
Fuel Injector 7	Top of engine, below fuel rail. See Fig. 12 .
Fuel Injector 8	Top of engine, below fuel rail. See Fig. 12 .
Pressure Control (PC) Solenoid Valve	Inside transmission. See Fig. 39 .
Reverse Inhibit Solenoid M/T)	On top left of transmission. See Fig. 34 .
Secondary Air Injection (AIR) Solenoid	Above PCM, between wheelhouse & firewall. See Fig. 31 .
Skip Shift Solenoid (M/T)	Under vehicle, on left side of transmission. See Fig. 34 .
Suspension Damper (Left Front)	Left front shock absorber. See Fig. 58 .
Suspension Damper (Left Rear)	Left rear shock absorber. See Fig. 58 .
Suspension Damper (Right Front)	Right front shock absorber. See Fig. 58 .
Suspension Damper (Right Rear)	Right rear shock absorber. See Fig. 58 .

Torque Converter Clutch Pulse Width Modulation (TCCPWM) Solenoid Valve	Inside transmission. See Fig. 39 .
Torque Converter Clutch (TCC) Solenoid Valve	Inside transmission. See Fig. 39 .
1-2 Shift Solenoid (SS) Valve	Inside transmission. See Fig. 39 .
2-3 Shift Solenoid (SS) Valve	Inside transmission. See Fig. 39 .
3-2 Shift Solenoid (SS) Valve Assembly	Inside transmission. See Fig. 39 .

SWITCHES

SWITCHES LOCATION

Component	Location
Automatic Transmission Fluid Pressure (TFP) Manual Valve Position Switch	Inside transmission. See Fig. 39 .
Backup Lamp Switch	On right side of manual transmission. See Fig. 53 .
Brake Fluid Level Switch	In master cylinder reservoir. See Fig. 25 .
Clutch Pedal Position Switch	On top of clutch pedal bracket. See Fig. 9 .
Clutch Pedal Start Switch	On bracket in front of brake pedal. See Fig. 9 .
Engine Oil Level Switch	Right side of oil pan. See Fig. 52 .
Folding Top Ajar Indicator Switch	Integral to folding top lid latch. See Fig. 46 .
Folding Top Release Switch	Under left side of storage compartment lid. See Fig. 46 .
Park Brake Switch	On parking brake lever. See Fig. 25 .
Park/Neutral Position (PNP) Switch	On left side of transmission. See Fig. 40 .
Rear Compartment Lid Ajar Switch	On rear compartment lid latch. See Fig. 24 .
Seat Belt Switch (Driver Connector)	In driver's seat belt buckle assembly. See Fig. 42 .
Stoplight Switch	On top of brake pedal support. See Fig. 9 .
Windshield Washer Fluid Level Switch	Inside solvent container. See Fig. 56 .
Windshield Washer Fluid Level Switch Connector	On solvent container. See Fig. 56 .

MISCELLANEOUS

MISCELLANEOUS LOCATION

Component	Location
A/C Compressor Clutch Diode	In forward lamp harness, near A/C clutch connector. See Fig. 21 .
Antenna Buffer	Bottom center of rear roof bow. See Fig. 10 .
Automatic Transmission 4L60-E	Rear of vehicle. See Fig. 40 .
Battery Cables	Right rear side of engine compartment. See Fig. 1 .

Battery	Right rear side of engine compartment. See Fig. 1 .
Brush (Horn Slip Ring)	Top of steering column. See Fig. 50 .
Data Link Connector	Under dash, below steering column. See Fig. 6 .
Defogger Grid	In rear window. See Fig. 45 .
Engine Grounding Strap	Behind left front wheel. See Fig. 3 .
Front Window Antenna (Coupe/Hardtop)	Top center of front window. See Fig. 55 .
Generator	Left front of engine compartment. See Fig. 28 .
Heads Up Display	Top left side of dash. See Fig. 51 .
Heads Up Display (HUD) Connector	Left side of dash. See Fig. 51 .
Horn Assembly	Lower right front of vehicle. See Fig. 23 .
Inline To Defogger Grid (Ground)	Near left rear speaker. See Fig. 59 .
Inline To Defogger Grid (Power)	Near right rear speaker. See Fig. 59 .
Radio Power Antenna (Convertible)	Behind right rear quarter inner trim panel. See Fig. 44 .
Rear Window Antenna	Top center of rear window. See Fig. 10 .
Remote Playback Device (CD Changer)	In rear compartment. See Fig. 24 .
Star Connector #1	In dash harness, near left side of BCM. See Fig. 8 .
Star Connector #2	In dash harness, near left side of BCM. See Fig. 8 .
Steering Column Lock	Top right side of steering column. See Fig. 7 .

CONNECTORS

CONNECTORS LOCATION

Component	Location
C100 (Black, 8 Pin)	At right skid bar, in front of horn. See Fig. 14 .
C102 (Black, 16 Pin)	At right rear of engine compartment. See Fig. 61 .
C105 (Gray, 2 Pin)	On engine, above left lower control arm.
C107	Left front corner of engine compartment. See Fig. 60 .
C108 (Gray, 2 Pin)	On engine, above right lower control arm.
C109 (Gray, 8 Pin)	At top center of left valve cover. See Fig. 12 .
C110 (Gray, 8 Pin)	At top center of right valve cover. See Fig. 13 .
C112 (Black, 2 Pin)	At top rear of engine, mounted to vacuum hose. See Fig. 16 .
C113 (Black, 2 Pin)	At right side of lower radiator support. See Fig. 61 .
C140 (Black, 10 Pin)	At right side of engine compartment, below battery. See Fig. 61 .
C142 (Gray, 20 Pin)	At right rear of engine compartment, below battery.
C144 (Gray, 20 Pin)	At right rear of engine compartment, below battery.
C146 (Black, 10 Pin)	At right rear of engine compartment, below battery.
C148 (Black, 10 Pin)	At right rear of engine compartment, below battery. See Fig. 61 .
C150 (Gray, 20 Pin)	At right rear of engine compartment, below battery. See Fig. 61 .
C152 (Black, 3 Pin)	At left side of engine compartment, on left wheelwell.
C200 (Black, 6 Pin)	In grommet, on right door. See Fig. 5 .

C201 (Black, 6 Pin)	In grommet, on left door. See Fig. 4 .
C202 (Blue, 10 Pin)	In grommet, on right door. See Fig. 5 .
C203 (Blue, 10 Pin)	In grommet, on left door. See Fig. 4 .
C204 (Black, 4 Pin)	At right of instrument panel fuse block, mounted to toe board, behind carpet. See Fig. 59 .
C206 (Black, 3 Pin)	Above body control module, taped to harness.
C207 (Black, 4 Pin)	On lower dash bar, for steering column lock. See Fig. 7 .
C208 (Black, 3 Pin)	At left side of steering column, on dash lower beam.
C209 (Black, 23 Pin)	On lower dash bar-headlight & turn signal switches. See Fig. 7 .
C210 (Black, 2 Pin)	At left side of steering column, on lower dash beam. See Fig. 7 .
C211 (Yellow, 2 Pin)	At left side of steering column, on lower dash bar. See Fig. 7 .
C212 (Black, 3 Pin)	At left side of steering column, on lower dash beam.
C213 (Yellow, 2 Pin)	Taped to dash harness, near BOSE signal processor. See Fig. 9 .
C215 (Natural, 10 Pin)	Behind hazard warning switch.
C217 (Black, 4 Pin)	At left side of steering column, on lower dash bar. See Fig. 7 .
C219 (Black, 6 Pin)	At left side of steering column, on lower dash beam. See Fig. 7 .
C220 (Black, 8 Pin)	Between dash harness & vanity mirror jumper.
C301 (Black, 6 Pin)	Under left seat. See Fig. 10 .
C302 (Black, 6 Pin)	Under right seat. See Fig. 59 .
C303 (Blue, 8 Pin)	Under left seat.
C400 (Black, 8 Pin)	At rear of right control arm.
C402 (Black, 10 Pin)	Between transmission harness & fuel tank jumper harness. See Fig. 32 .
C403 (Black, 2 Pin)	On frame, below left shock absorber.
C406 (Black, 2 Pin)	On frame, below right shock absorber.
C410 (1 Pin)	Front body harness to antenna/defogger jumper harness.
C412 (Black, 4 Pin)	Between left & right fuel tanks. See Fig. 32 .
C414 (Black, 6 Pin)	Between left & right fuel tanks. See Fig. 32 .

GROUND S

GROUND S LOCATION

Component	Location
G101	On left frame rail, near brake pressure modulator valve. See Fig. 18 .
G102	On top of right frame rail, behind right headlight. See Fig. 17 .
G103	On left frame rail, near brake pressure modulator valve. See Fig. 61 .
G104	On right frame rail, below battery tray. See Fig. 1 .
G105	On left rear side of engine. See Fig. 15 .
G106	On right side of engine, above starter.
G107	At top left rear of engine. See Fig. 16 .
G108	On frame rail, below battery tray. See Fig. 2 .

G201	At base of left "A" pillar. See Fig. 4 .
G202	At base of right "A" pillar. See Fig. 5 .
G205	Behind left seat at antenna module. See Fig. 10 .
G301	Behind left seat at antenna module. See Fig. 2 .
G302	At right "B" pillar. See Fig. 2 .
G401	At rear of vehicle, on inner side of left frame rail. See Fig. 2 .
G402	At rear of vehicle, on inner side of right frame rail. See Fig. 2 .

SPLICES

SPLICES LOCATION

Component	Location
SP100	In forward light harness, at breakout to right headlight door opening connector. See Fig. 17 .
SP101	In forward light harness, near brake pressure modulator valve. See Fig. 18 .
SP102	Taped to forward light jumper, 10 cm left of C100. See Fig. 14 .
SP201	In dash harness. See Fig. 4 .
SP202	In dash harness. See Fig. 5 .
SP203	In dash harness. See Fig. 4 .
SP208	In dash harness, on right side of dash.
SP302	In front body harness, 83.5 cm from right power seat breakout. See Fig. 59 .
SP400	In rear body harness, taped back to harness, between backup light & tail/stop light breakout.
SP402	In rear body harness, taped back to harness, between auto fuse & right license light breakout.
S100	In right ignition control module jumper, 6 cm from breakout to C110.
S101	In left ignition control module jumper, 6 cm from breakout to C109.
S102	In right ignition control module jumper, 5 cm from breakout to C110.
S103	In left ignition control module jumper, 5 cm from breakout to C109.
S104	In right ignition control module jumper, 4 cm from breakout to ignition coil/module No. 4.
S105	In left ignition control module jumper, 4 cm from breakout to ignition coil/module No. 5.
S106	In forward light harness, 12.5 cm from breakout to EBCM connector. See Fig. 60 .
S107	In forward light harness, 20 cm from breakout to EBCM connector. See Fig. 60 .
S108	In forward light harness, 6 cm from breakout to EBCM connector. See Fig. 61 .
S109	In forward light harness, 10 cm from breakout to A/C compressor clutch connector.
S110	In engine harness, 39 cm from main harness leading to PCM.
S112	In engine harness, 6 cm from camshaft position sensor breakout.
S120	In engine harness, 15 cm from main harness, in branch leading to powertrain control module connectors.
S200	In dash harness, 22.5 cm from inside rear view mirror breakout.
S201	In dash harness, 35 cm from HVAC control head.

S202	In dash harness, 39.5 cm from inside rear view mirror breakout.
S203	In dash harness, 6 cm from breakout to BCM.
S204	In engine harness, 6.5 cm from breakout to C150.
S205	In dash harness, 6.5 cm from breakout to data link connector.
S206	In dash harness, 5 cm from breakout to blower motor control module connector.
S208	In dash harness, 32.5 cm from radio connectors.
S210	In dash harness, 10 cm from breakout to blower motor control module.
S212	In dash harness, 22.5 cm from electronic accessory plug connector.
S213	In dash harness, 7.5 cm right of brake switch connector breakout.
S215	In dash harness, 6.5 cm left of inflatable restraint dash breakout.
S300-IDC	In left power seat harness, 4 cm from breakout to right seat relay center connection.
S301-IDC	In left power seat harness, 2.5 cm from breakout for C301.
S302	In front body harness, 12 cm from right speaker breakout. See Fig. 59 .
S303	In front body harness, 15 cm from right speaker breakout. See Fig. 59 .
S304	In front body harness, 22.5 cm from right rear speaker breakout. See Fig. 59 .
S308	In dash harness, 19 cm from yaw rate sensor connector.
S310	In dash harness, 11 cm from yaw rate sensor connector.
S312	In front body harness, 20 cm from SP302 breakout. See Fig. 59 .
S314	In front body harness, 20 cm from SP302 breakout. See Fig. 59 .
S391	In left power seat harness, under seat base.
S392	In left power seat harness, under seat base.
S400	In transmission harness, 6.5 cm from C402 breakout. See Fig. 11 .
S402	In transmission harness, 55 cm from right rear shock absorber breakout.
S408	In fuel tank jumper harness, 6.5 cm from C402 breakout.
S410	In fuel tank jumper harness, 81.5 cm from C408 breakout.
S412	In right fuel tank harness, 22.5 cm from breakout to C414.
S481	In rear body harness, 6.5 cm from breakout to left back-up light.
S482	In rear body harness, 21.5 cm from SP400 breakout. See Fig. 11 .
S484	In rear body harness, 8 cm from SP400 breakout. See Fig. 11 .
S492	In rear body harness, 6.5 cm from right turn signal breakout. See Fig. 11 .
S498	At right rear backup light breakout. See Fig. 11 .
S501-IDC	In left door harness, 6 cm from outside rear view mirror connector breakout.
S503	In antenna/defogger jumper harness, 10 cm from rear defogger.
S505	In antenna/defogger jumper harness, 32 cm radio antenna module.
S507	In antenna/defogger jumper harness, 20 cm from c410 breakout.
S509	In antenna/defogger jumper, 20 cm from rear defogger.
S600-IDC	In right door harness, 6 cm from outside rear view mirror breakout.

COMPONENT LOCATION GRAPHICS

NOTE:

Figures may show multiple component locations. Refer to appropriate table for proper figure references.

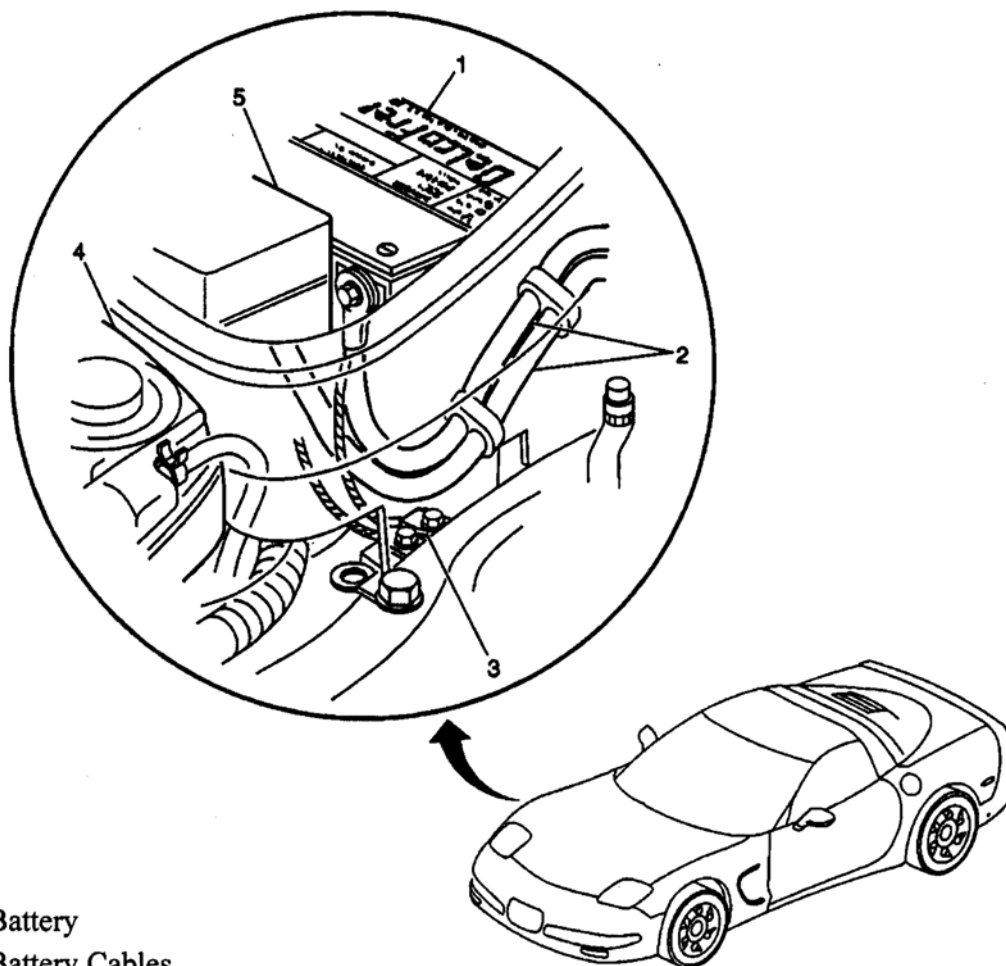

- (1) Battery
- (2) Battery Cables
- (3) G104
- (4) Engine Coolant Reservoir
- (5) Fuse Block-Underhood

G00259081

Fig. 1: Right Rear Corner Of Engine Compartment
Courtesy of GENERAL MOTORS CORP.

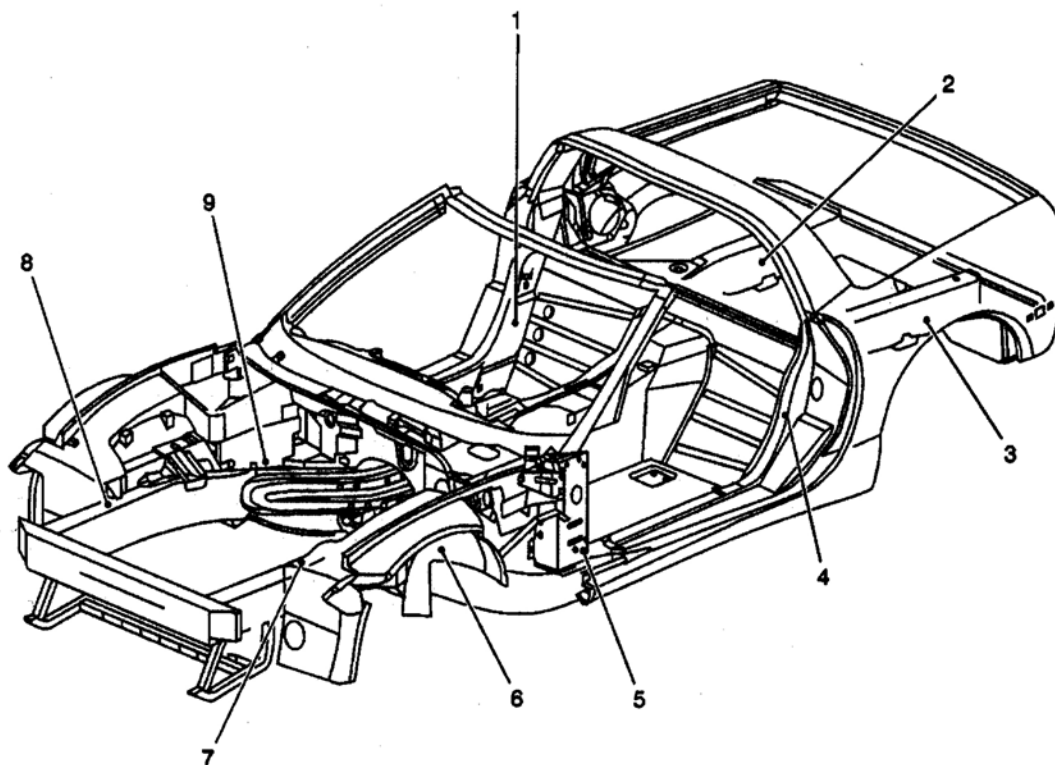

- (1) G302
- (2) G402
- (3) G401
- (4) G205 and G301
- (5) G201
- (6) Grounding Point for Engine Ground Strap
- (7) G101
- (8) G102
- (9) G104 and G108

G00259082

Fig. 2: Vehicle Overview
Courtesy of GENERAL MOTORS CORP.

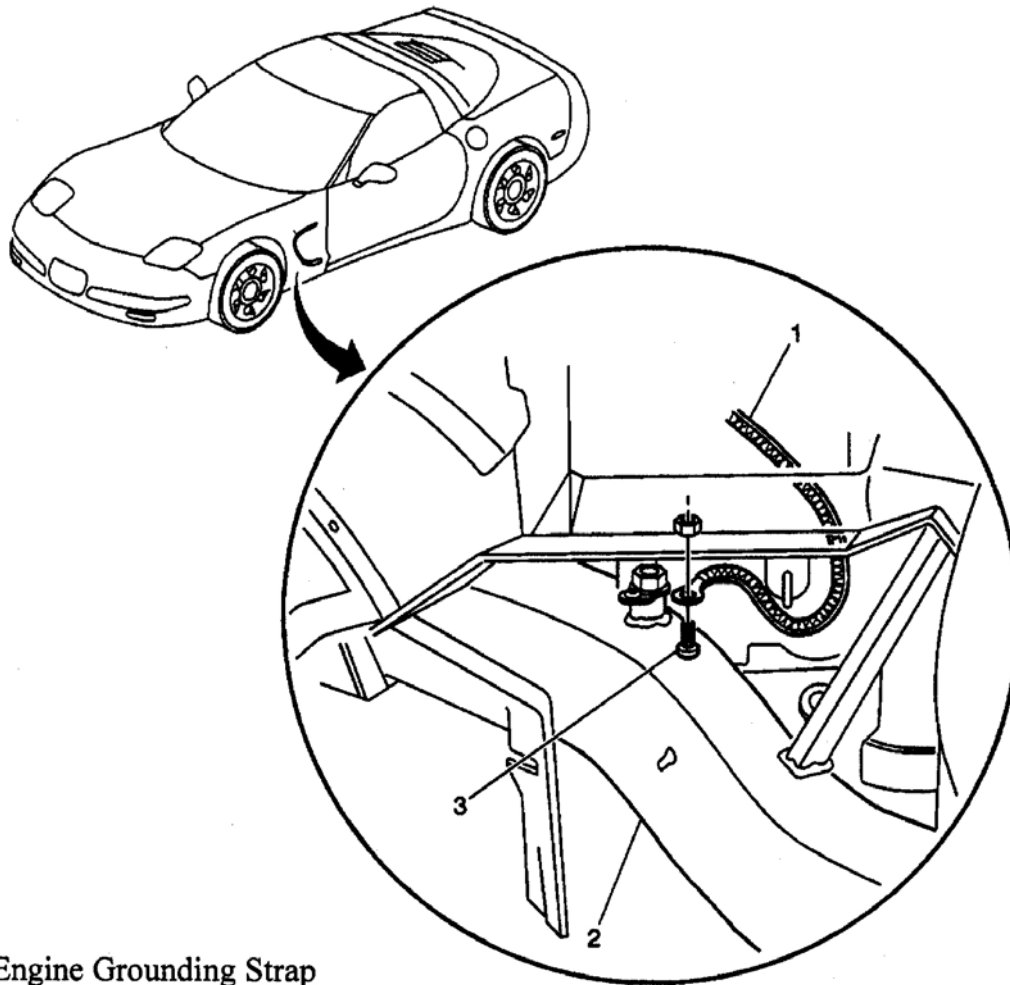

- (1) Engine Grounding Strap
- (2) Frame Rail-LH
- (3) Engine Grounding Strap Location

G00259083

Fig. 3: Behind Left Front Wheel
Courtesy of GENERAL MOTORS CORP.

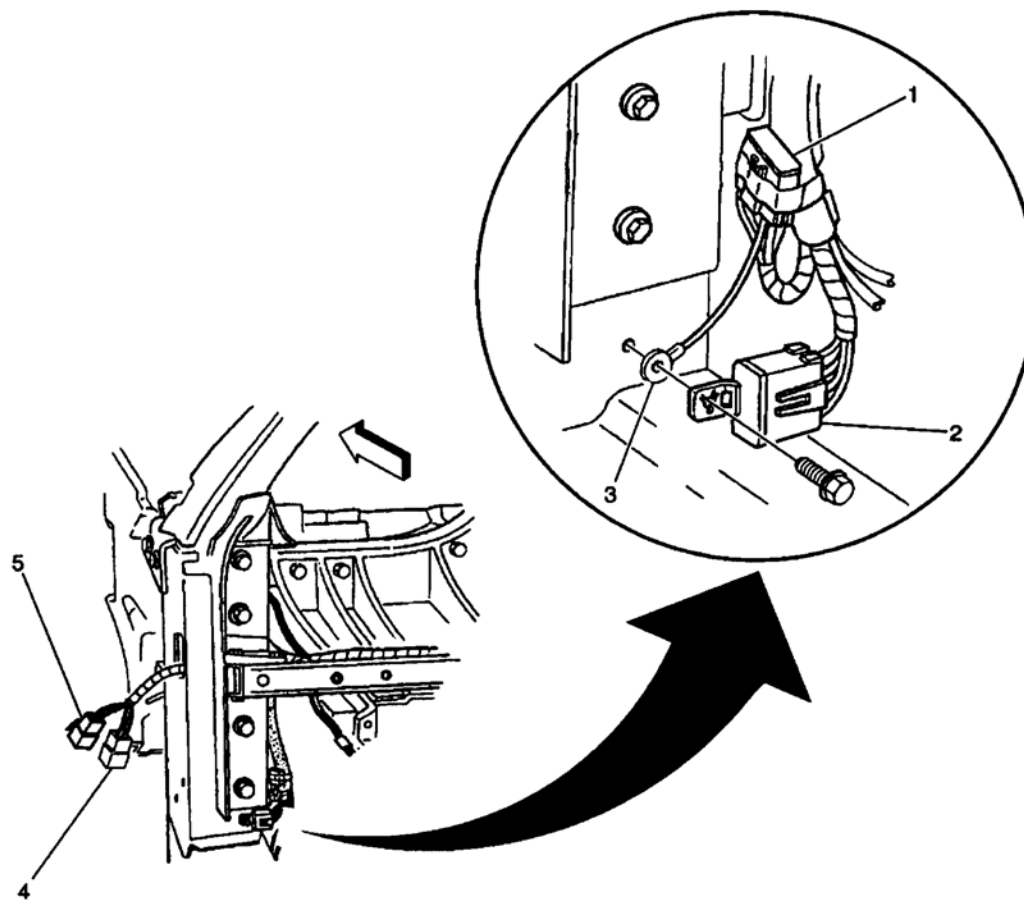

- (1) SP203
- (2) SP201
- (3) G201
- (4) C203
- (5) C201

G00259084

Fig. 4: Bottom Of Left "A" Pillar
Courtesy of GENERAL MOTORS CORP.

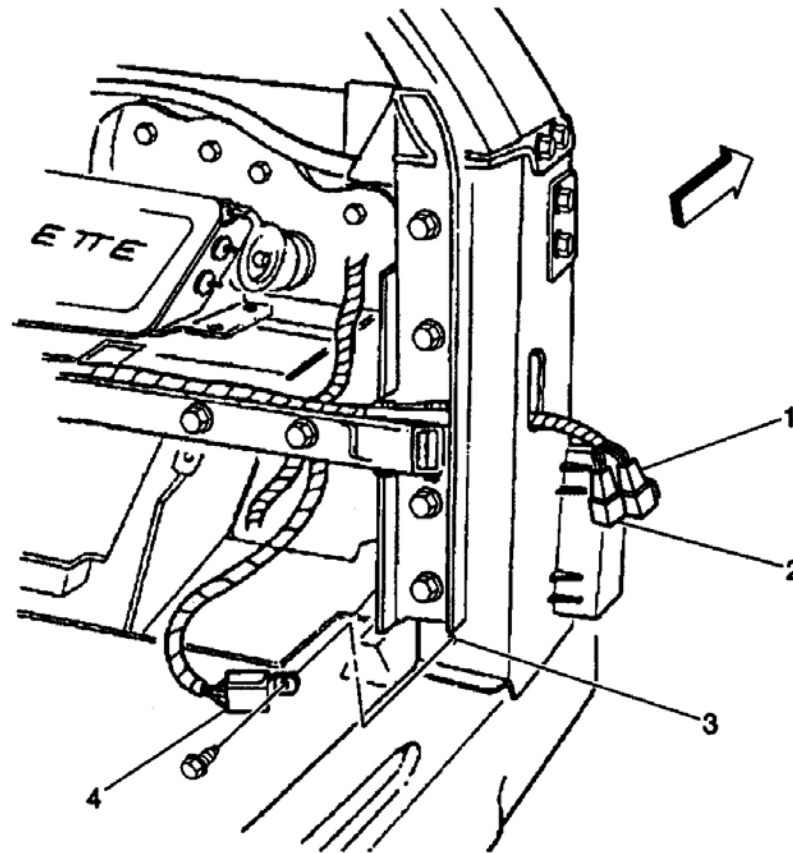

- (1) C202
- (2) C200
- (3) G202
- (4) SP202

G00259085

Fig. 5: Bottom Of Right "A" Pillar
Courtesy of GENERAL MOTORS CORP.

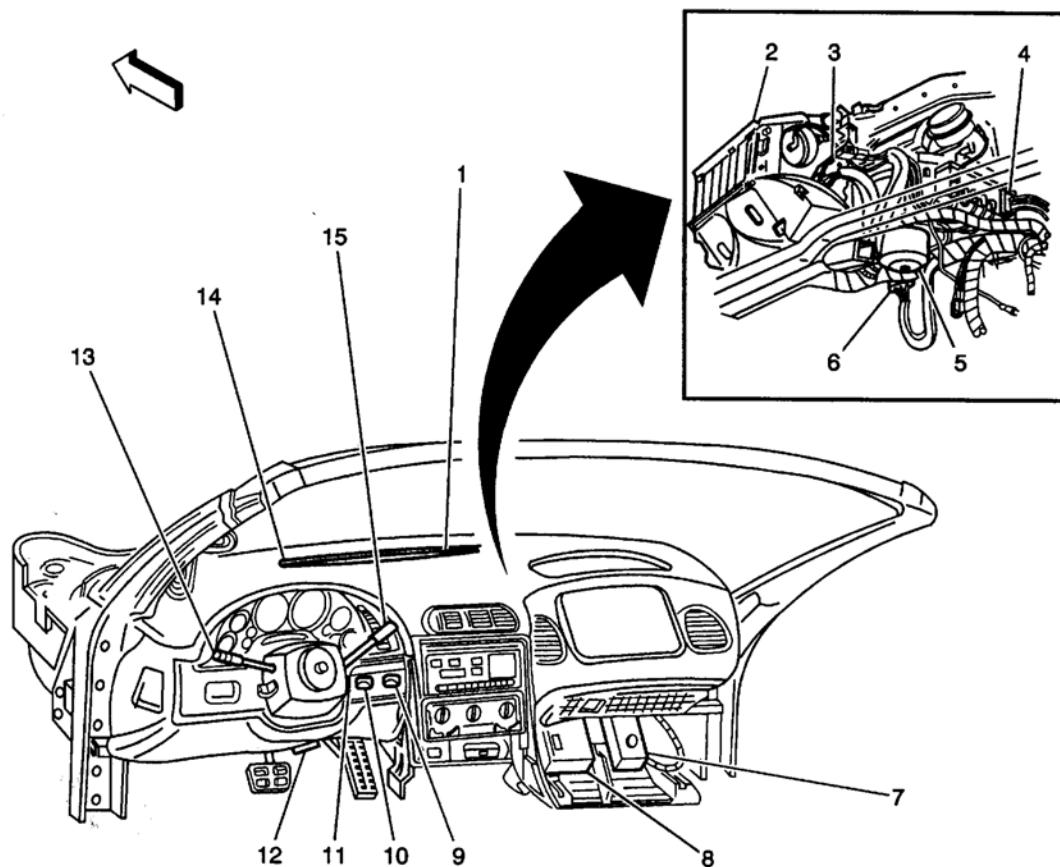

- | | |
|------------------------------------|--------------------------------------|
| (1) Sunload Sensor | (10) Air Temperature Sensor - Inside |
| (2) HVAC Module Assembly | (11) Telescoping Actuator Switch |
| (3) Air Temperature Actuator (C60) | (12) Data Link Connector (DLC) |
| (4) Vacuum Control Assembly (CJ2) | (13) Multifunction Turn Signal Lever |
| (5) Blower Motor | (14) Ambient Light Sensor |
| (6) Blower Motor Control Processor | (15) Windshield Wiper/Washer Switch |
| (7) Fuse Block-IP | |
| (8) Body Control Module (BCM) | |
| (9) Ignition Switch | |

G00259086

Fig. 6: Dash
 Courtesy of GENERAL MOTORS CORP.

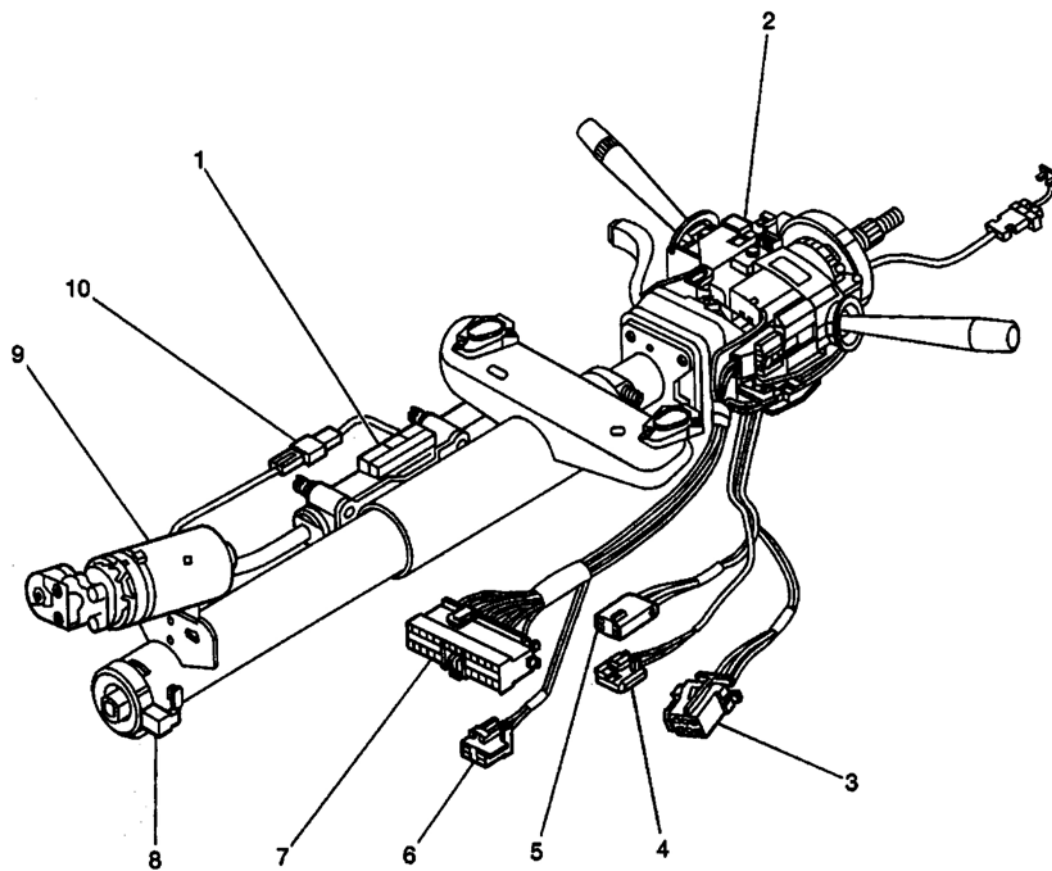

- (1) Telescoping Sensor
- (2) Steering Column Lock
- (3) C219
- (4) C207
- (5) C211
- (6) C217
- (7) C209
- (8) Steering Wheel Position Sensor
- (9) Telescoping Drive Motor
- (10) C210

G00259089

Fig. 7: Steering Column
 Courtesy of GENERAL MOTORS CORP.

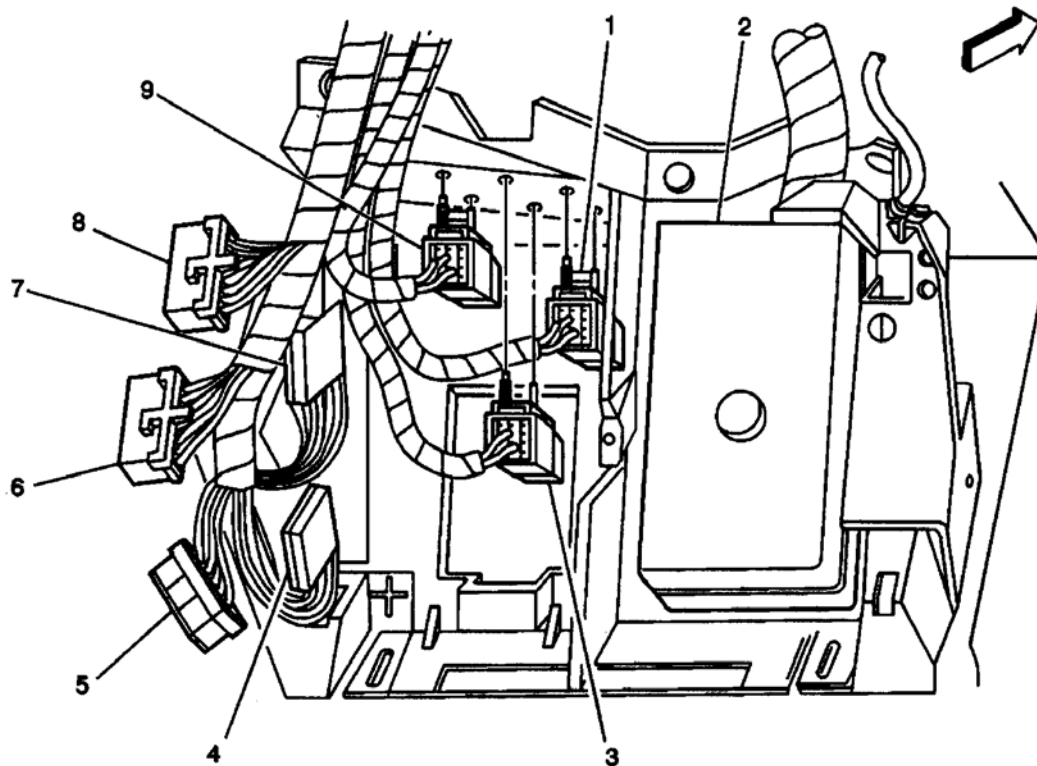

- (1) Theft Deterrent Relay
- (2) Fuse Block-IP
- (3) Blower Motor Relay
- (4) Star Connector #2
- (5) Body Control Module (BCM) C3
- (6) Body Control Module (BCM) C1
- (7) Star Connector #1
- (8) Body Control Module (BCM) C2
- (9) Steering Column Lock Relay

G00259090

Fig. 8: Under Right Side Of Dash
Courtesy of GENERAL MOTORS CORP.

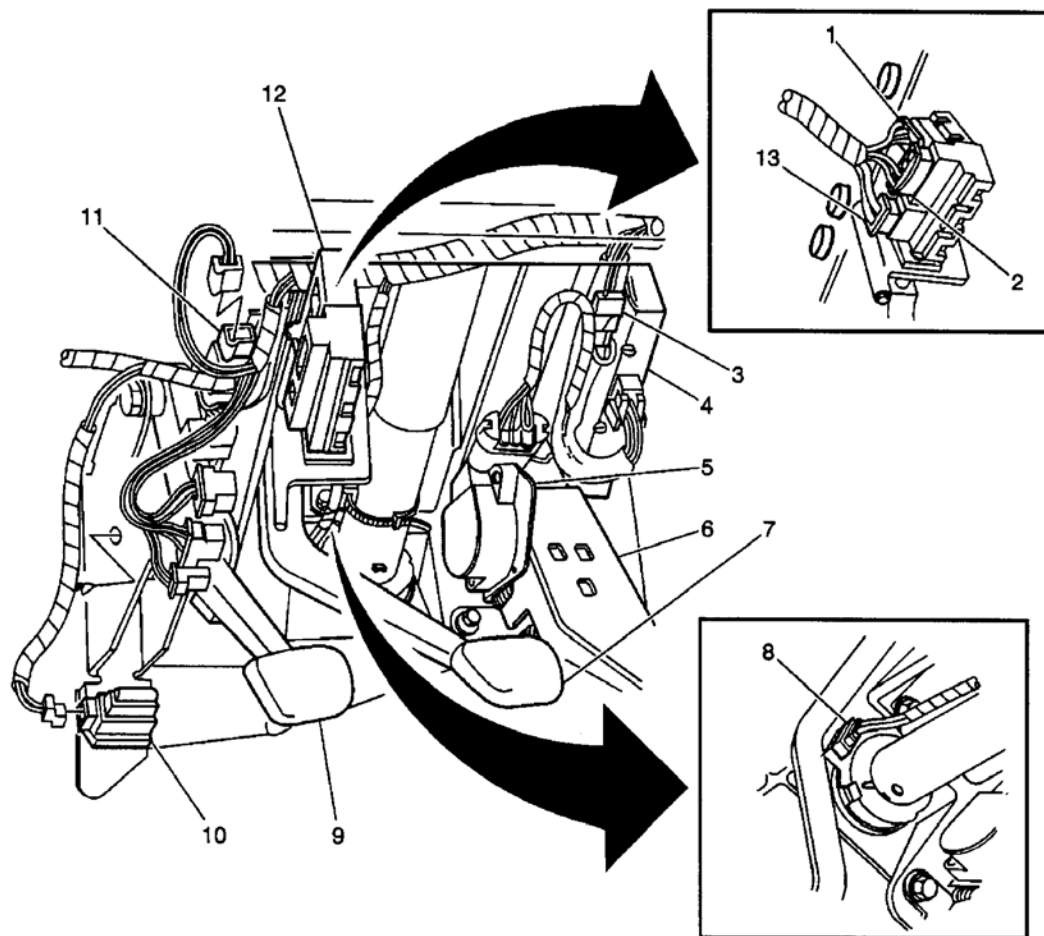

- | | |
|---------------------------------------------|------------------------------------|
| (1) Stop Lamp Switch C1 | (10) Clutch Pedal Start Switch |
| (2) Stop Lamp Switch C3 | (11) Clutch Pedal Position Switch |
| (3) C213 | (12) Stop Lamp Switch |
| (4) Bose Signal Processor | (13) Stop Lamp Switch Connector C2 |
| (5) Accelerator Pedal Position (APP) Sensor | |
| (6) Accelerator Pedal | |
| (7) Brake Pedal | |
| (8) Steering Wheel Position Sensor | |
| (9) Clutch Pedal | |

G00259091

Fig. 9: Under Left Side Of Dash
Courtesy of GENERAL MOTORS CORP.

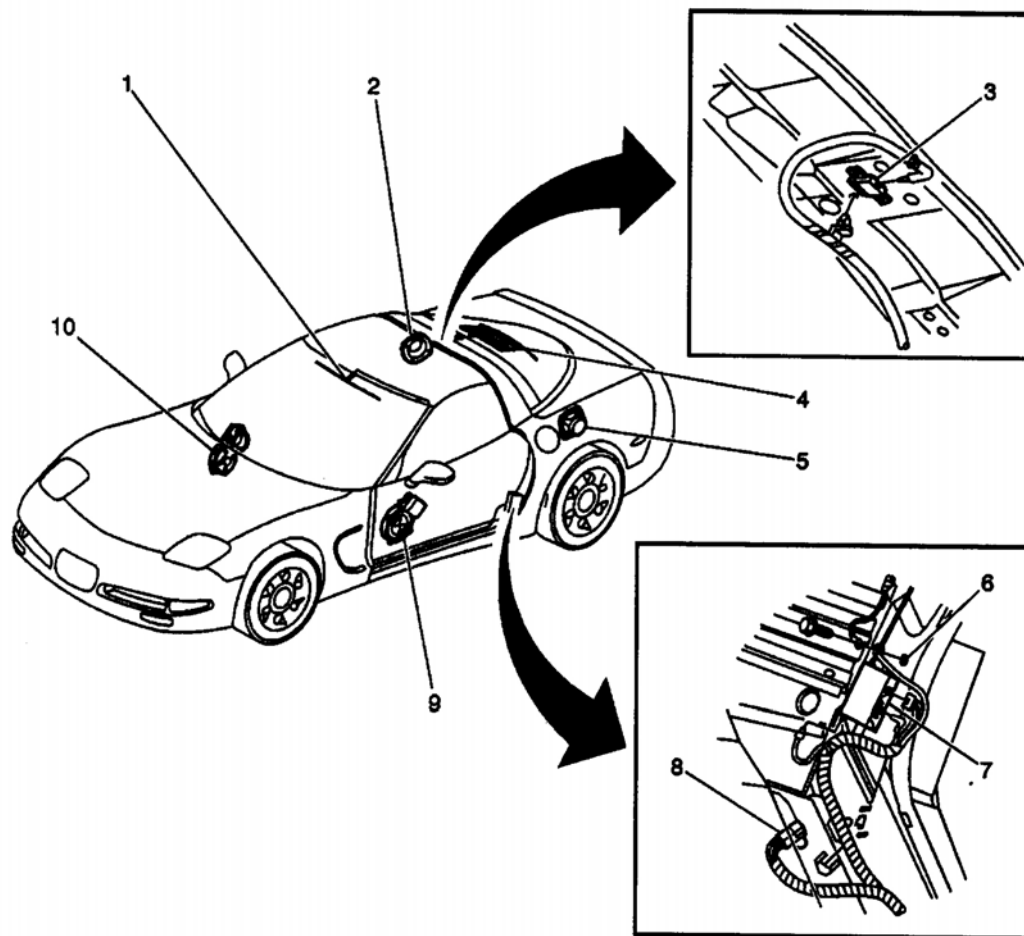

- (1) Front Window Antenna
- (2) Speaker-RR
- (3) Antenna Buffer
- (4) Rear Window Antenna
- (5) Speaker-LR
- (6) G205
- (7) Radio Antenna Module (Coupe)
- (8) C301
- (9) Speaker-LF Door

(10) Speaker-RF Door

G00259092

Fig. 10: Sound System Overview
Courtesy of GENERAL MOTORS CORP.

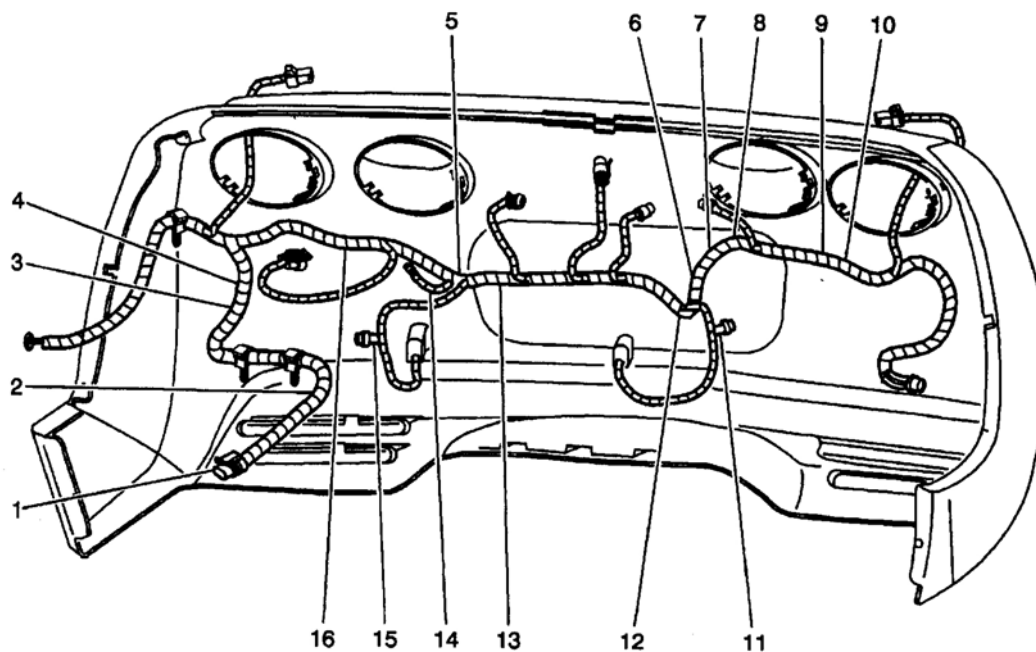

- | | |
|-------------------------|-------------------------------------------|
| (1) C400 | (10) S494 - Japan/Europe |
| (2) S420 - Europe | (11) License Lamp Inline Fuse-RH (Export) |
| (3) S496 - Japan | (12) S498 |
| (4) S490 - Japan/Europe | (13) S483 - Japan/Europe |
| (5) S485 - Japan | (14) S481 - Japan/Domestic |
| (6) S482 | (15) License Lamp Inline Fuse-LH (Export) |
| (7) S484 - Domestic | (16) Sp400, Sp402 - Export |
| (8) S480 - Japan/Europe | |
| (9) S492 - Domestic | |

G00259093

Fig. 11: Rear Of Body
Courtesy of GENERAL MOTORS CORP.

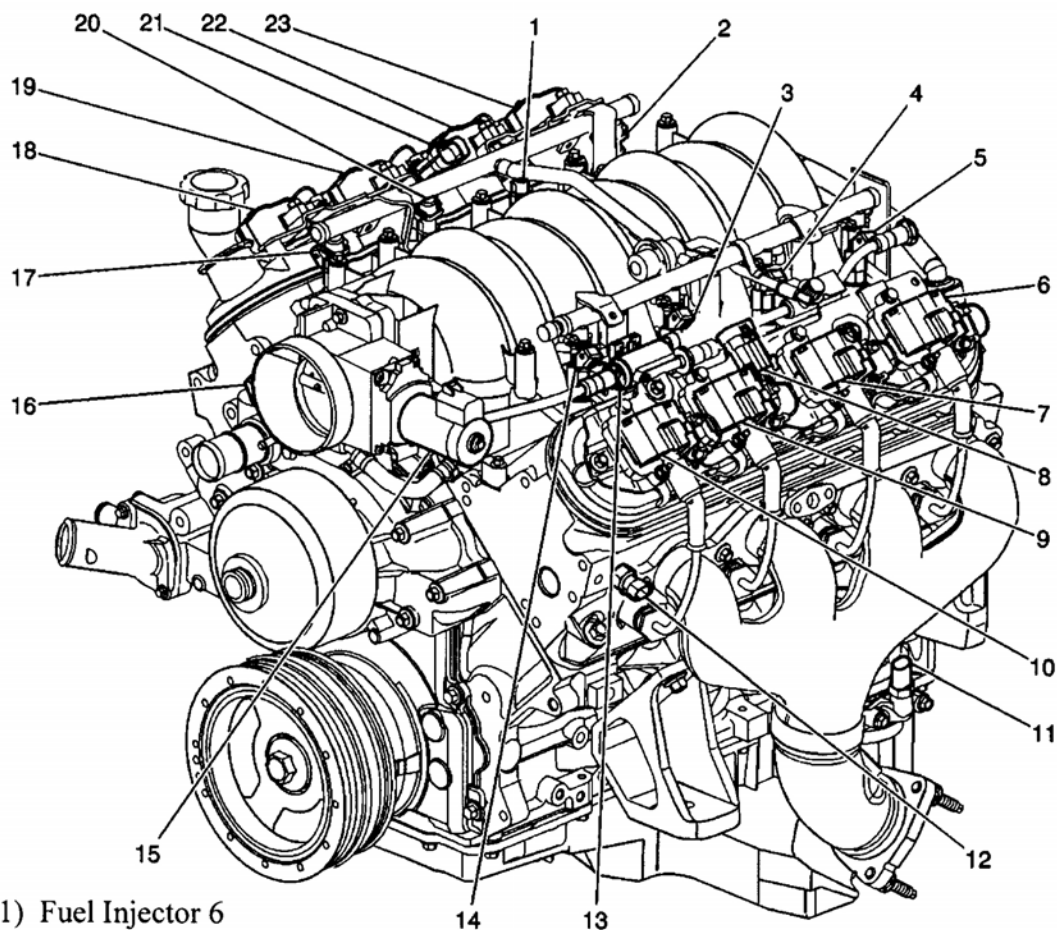

- (1) Fuel Injector 6
- (2) Fuel Injector 8
- (3) Fuel Injector 3
- (4) Fuel Injector 5
- (5) Fuel Injector 7
- (6) Ignition Coil/Module 7
- (7) Ignition Coil/Module 5
- (8) C109
- (9) Ignition Coil/Module 3

G00259094

Fig. 12: Left Front Of Engine (1 Of 2)
Courtesy of GENERAL MOTORS CORP.

- (10) Ignition Coil/Module 1
- (11) Engine Oil Temperature (EOT) Sensor
- (12) Engine Coolant Temperature (ECT) Sensor
- (13) Evaporative Emission (EVAP) Canister Purge Solenoid
- (14) Fuel Injector 1
- (15) Throttle Actuator Control (TAC) Motor
- (16) Throttle Position (TP) Sensor
- (17) Fuel Injector 2
- (18) Ignition Coil/Module 2
- (19) Ignition Coil/Module 4
- (20) Fuel Injector 4
- (21) C110
- (22) Ignition Coil/Module 6
- (23) Ignition Coil/Module 8

G00259095

Fig. 13: Left Front Of Engine (2 Of 2)
Courtesy of GENERAL MOTORS CORP.

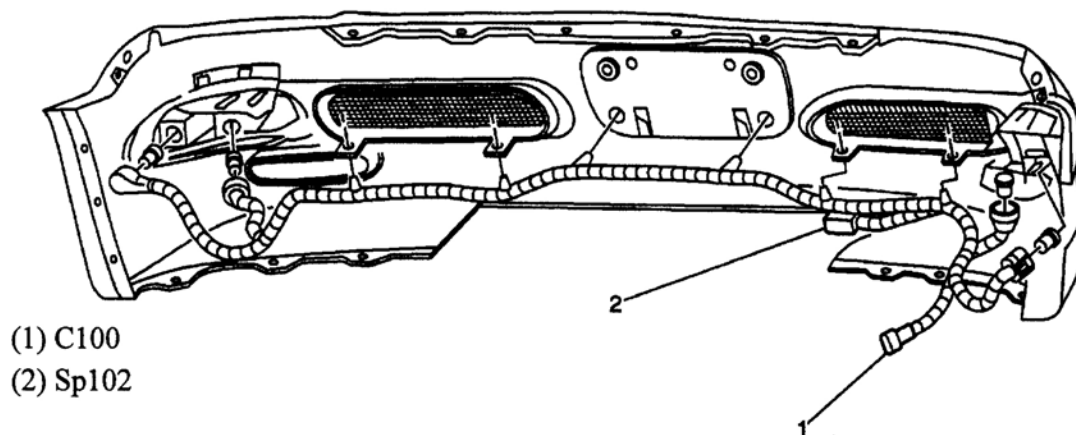

G00259096

Fig. 14: Forward Lamp Jumper Harness

Courtesy of GENERAL MOTORS CORP.

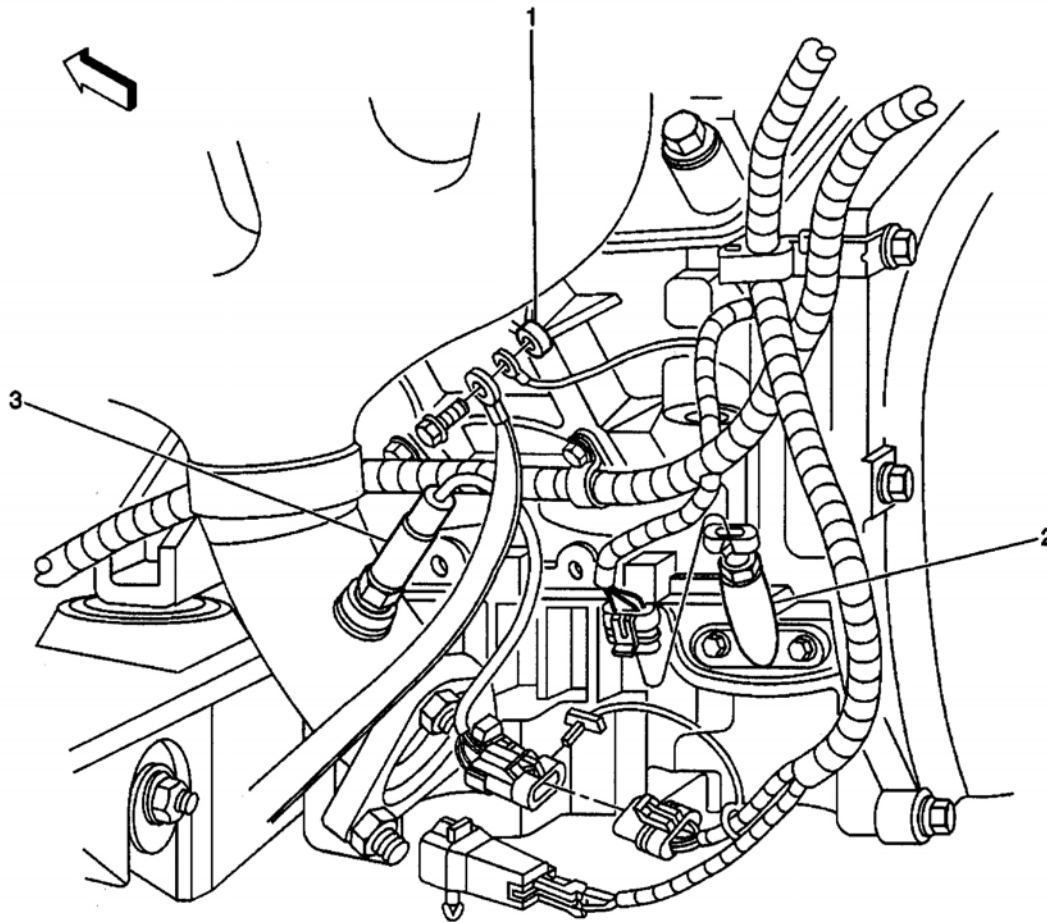

- (1) G105
- (2) Engine Oil Temperature (EOT) Sensor
- (3) Heated Oxygen Sensor (HO2S) Bank 1 Sensor 1

G00259097

Fig. 15: Lower Left Side Of Engine
Courtesy of GENERAL MOTORS CORP.

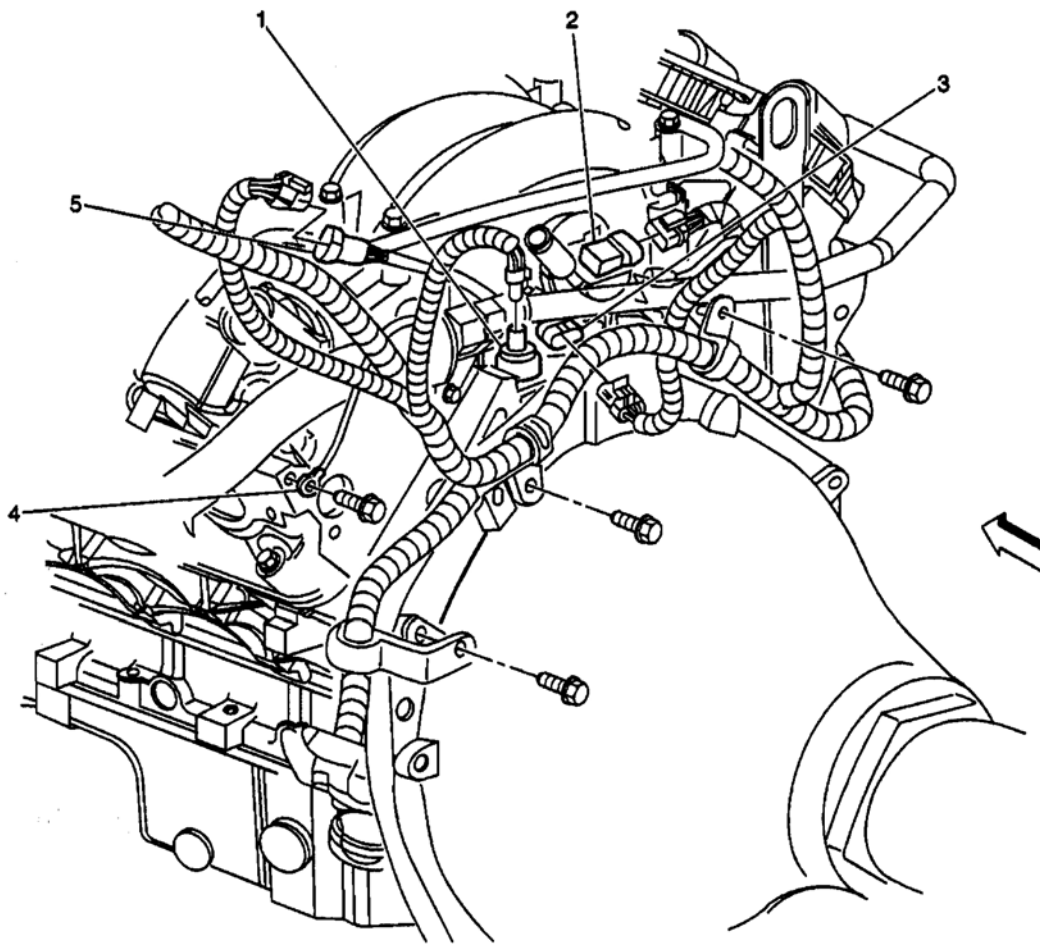

- (1) Engine Oil Pressure (EOP) Sensor
- (2) Manifold Absolute Pressure (MAP) Sensor
- (3) Camshaft Position (CMP) Sensor
- (4) G107
- (5) C112

G00259098

Fig. 16: Rear Of Engine
Courtesy of GENERAL MOTORS CORP.

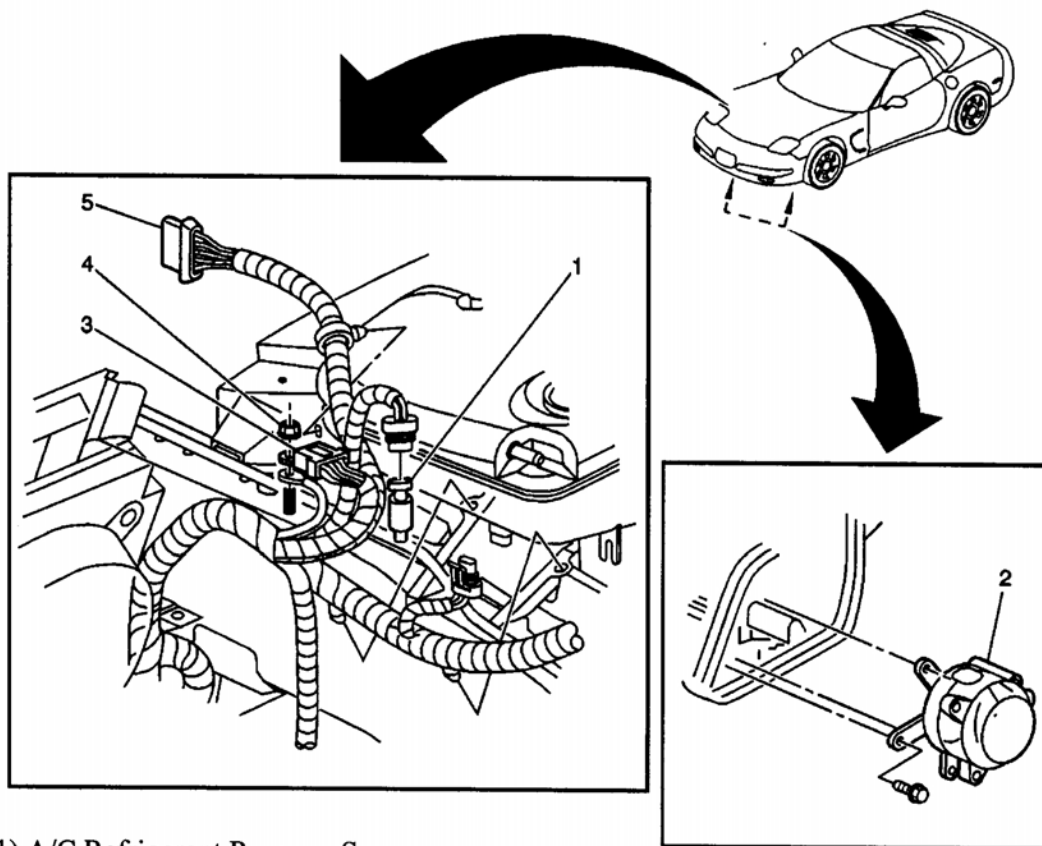

- (1) A/C Refrigerant Pressure Sensor
- (2) Secondary Air Injection (AIR) Pump
- (3) SP100
- (4) G102
- (5) Headlamp Door Assembly-Right Connector

G00259099

Fig. 17: Front Of Engine Compartment
Courtesy of GENERAL MOTORS CORP.

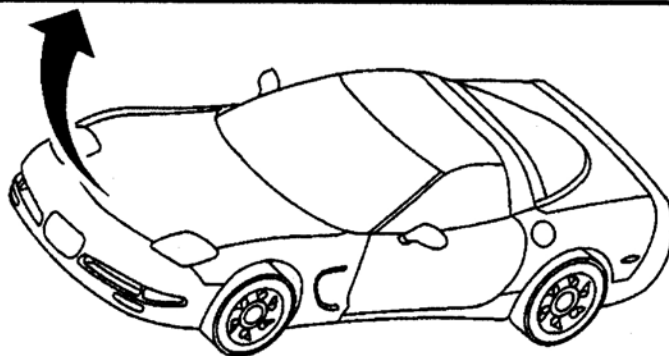
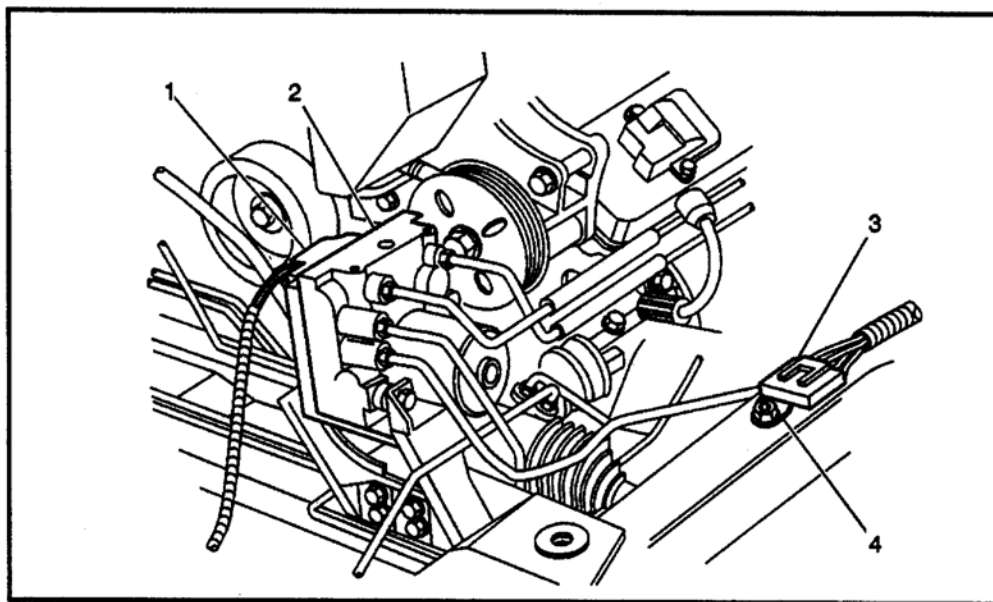

- (1) Electronic Brake Control Module (EBCM)
- (2) Brake Pressure Modulator Valve (BPMV)
- (3) SP101
- (4) G101

G00259100

Fig. 18: Left Front Of Engine Compartment
Courtesy of GENERAL MOTORS CORP.

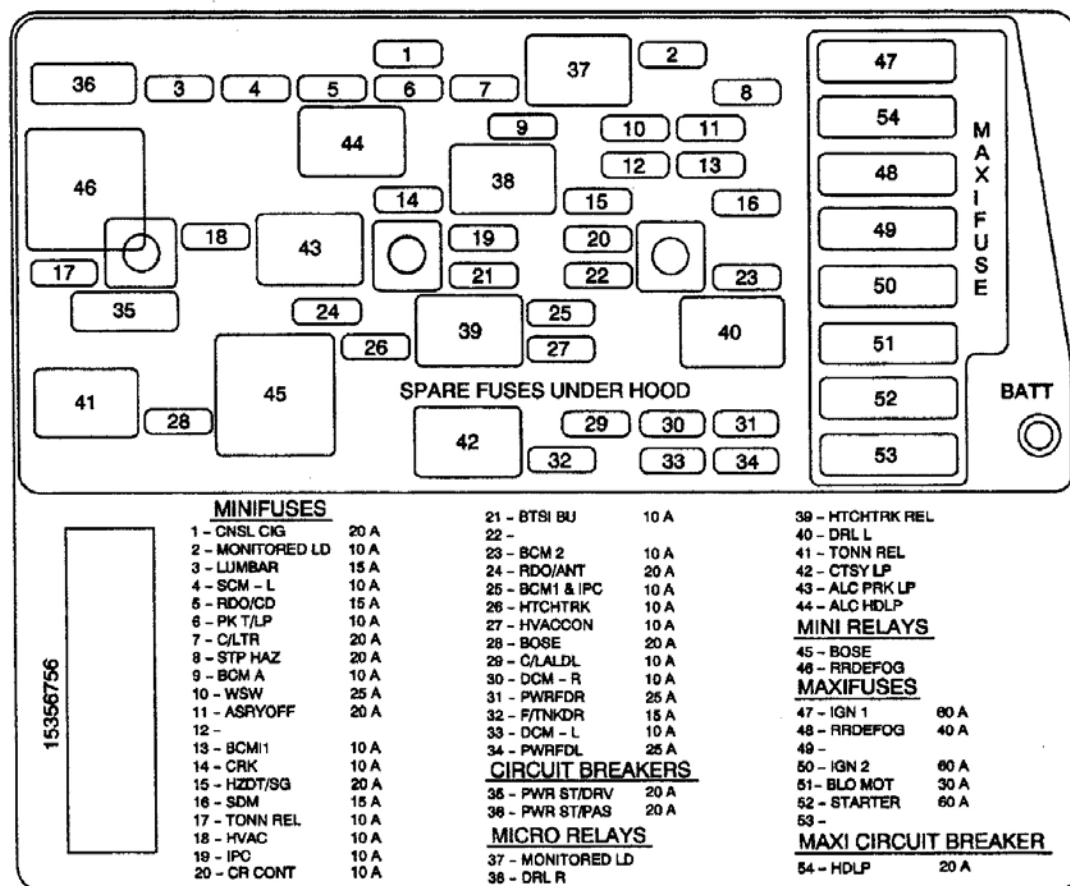

G00260559

Fig. 19: I/P Fuse Block

Courtesy of GENERAL MOTORS CORP.

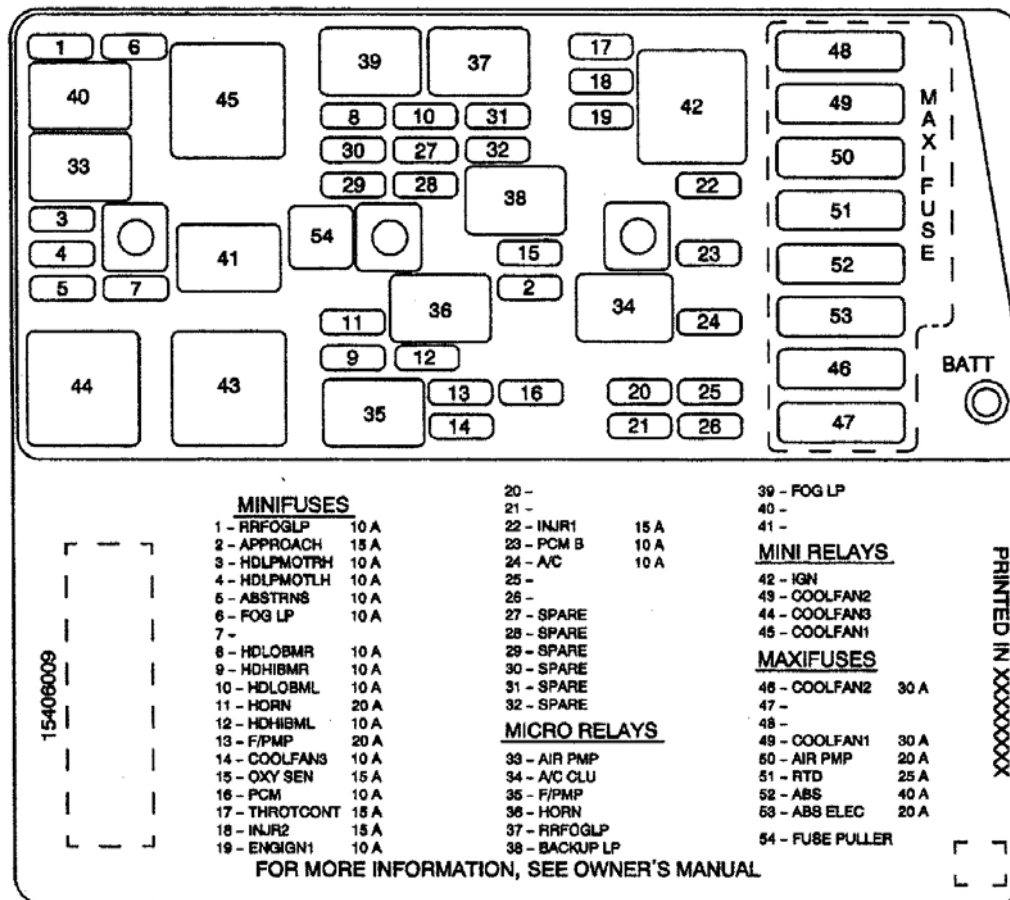

G00260562

Fig. 20: Underhood Fuse Block
Courtesy of GENERAL MOTORS CORP.

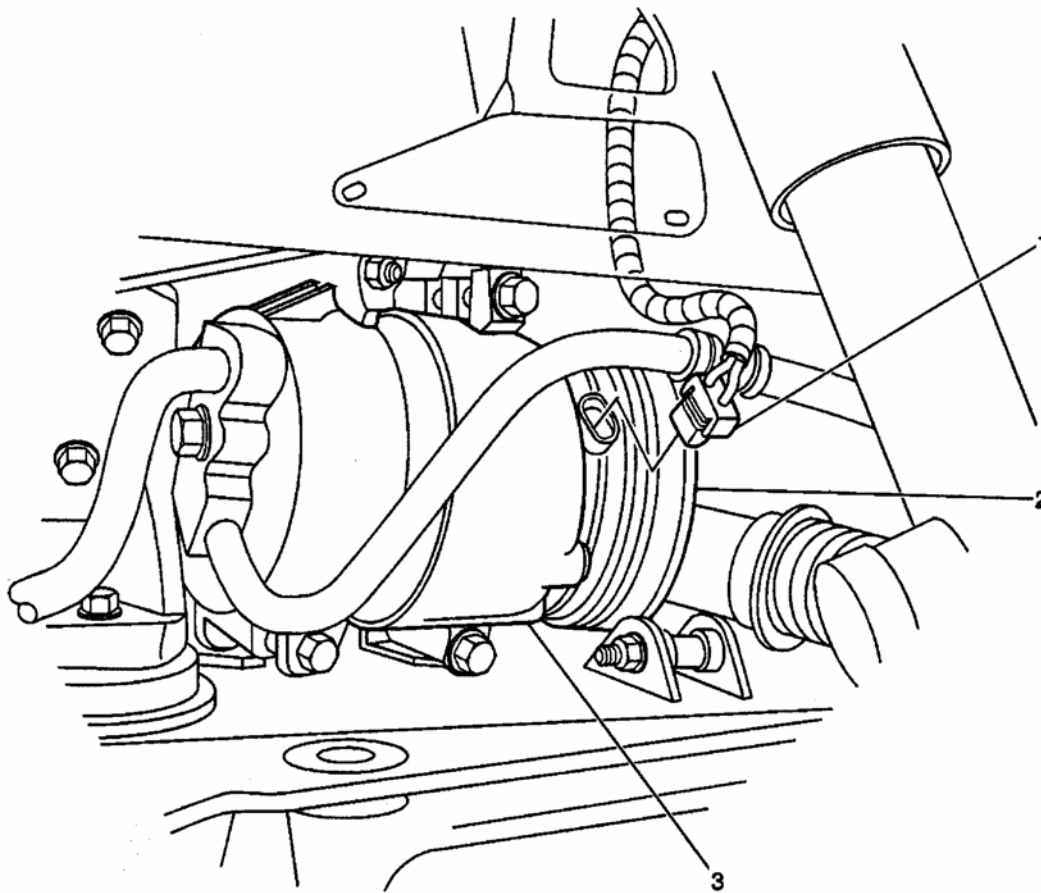

- (1) A/C Compressor Clutch Diode
- (2) A/C Compressor Clutch
- (3) A/C Compressor

G00260565

Fig. 21: Right Front Of Engine Block
Courtesy of GENERAL MOTORS CORP.

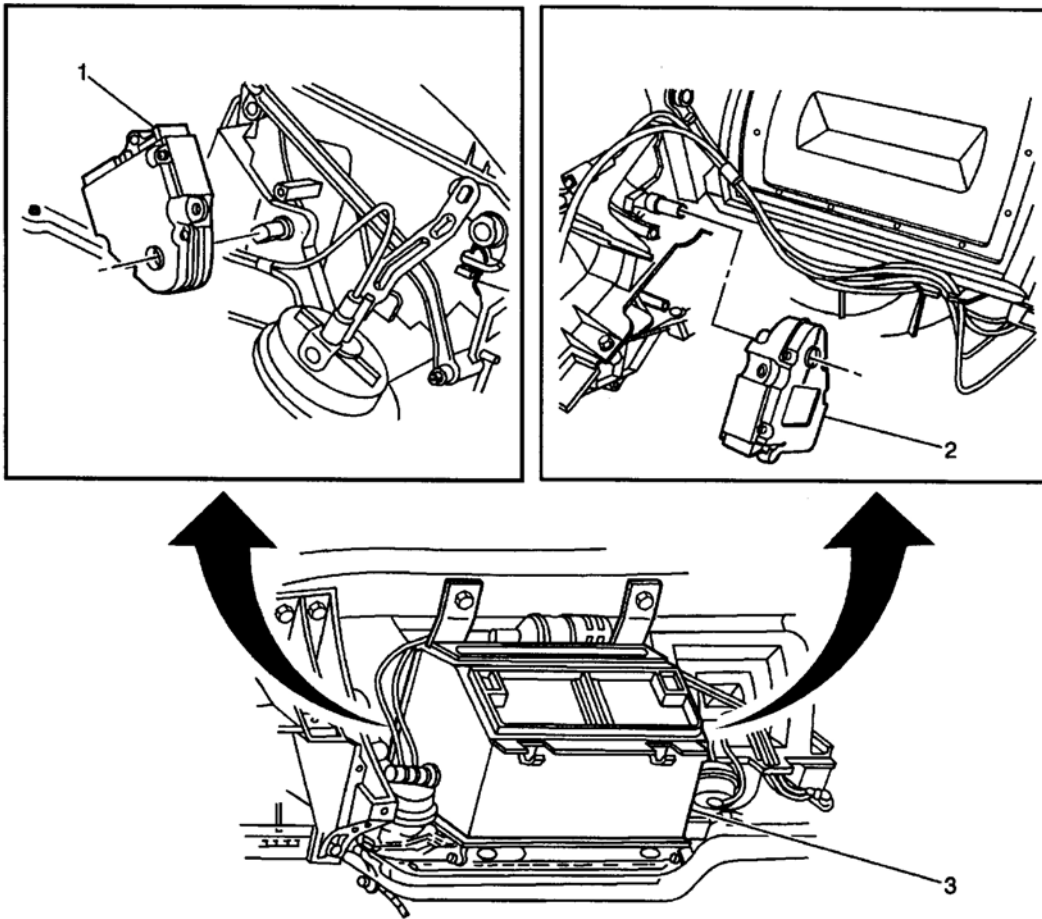

- (1) Air Temperature Actuator - Left
- (2) Air Temperature Actuator - Right
- (3) HVAC Module Assembly

G00260566

Fig. 22: Behind Center Of Dash
Courtesy of GENERAL MOTORS CORP.

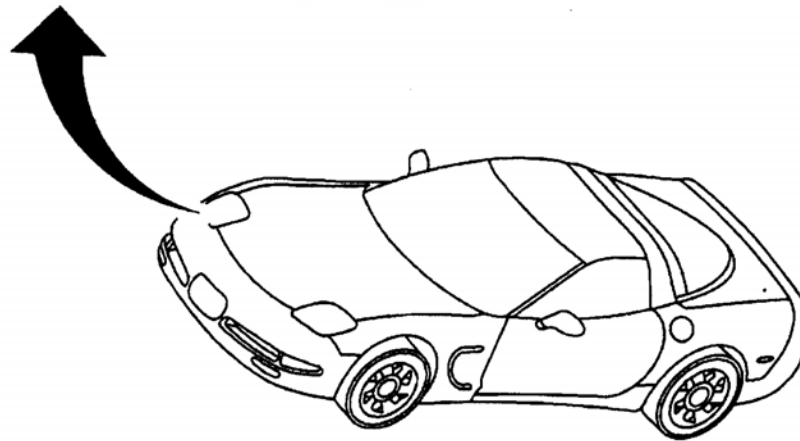
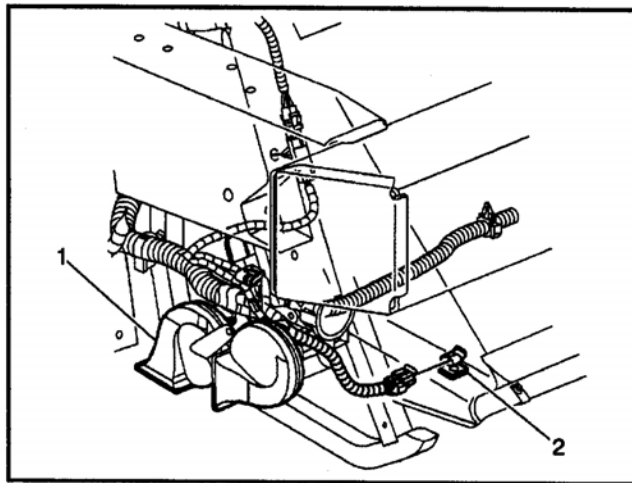

(1) Horn Assembly

(2) Ambient Air Temperature Sensor

G00260567

Fig. 23: Lower Right Front Of Vehicle
Courtesy of GENERAL MOTORS CORP.

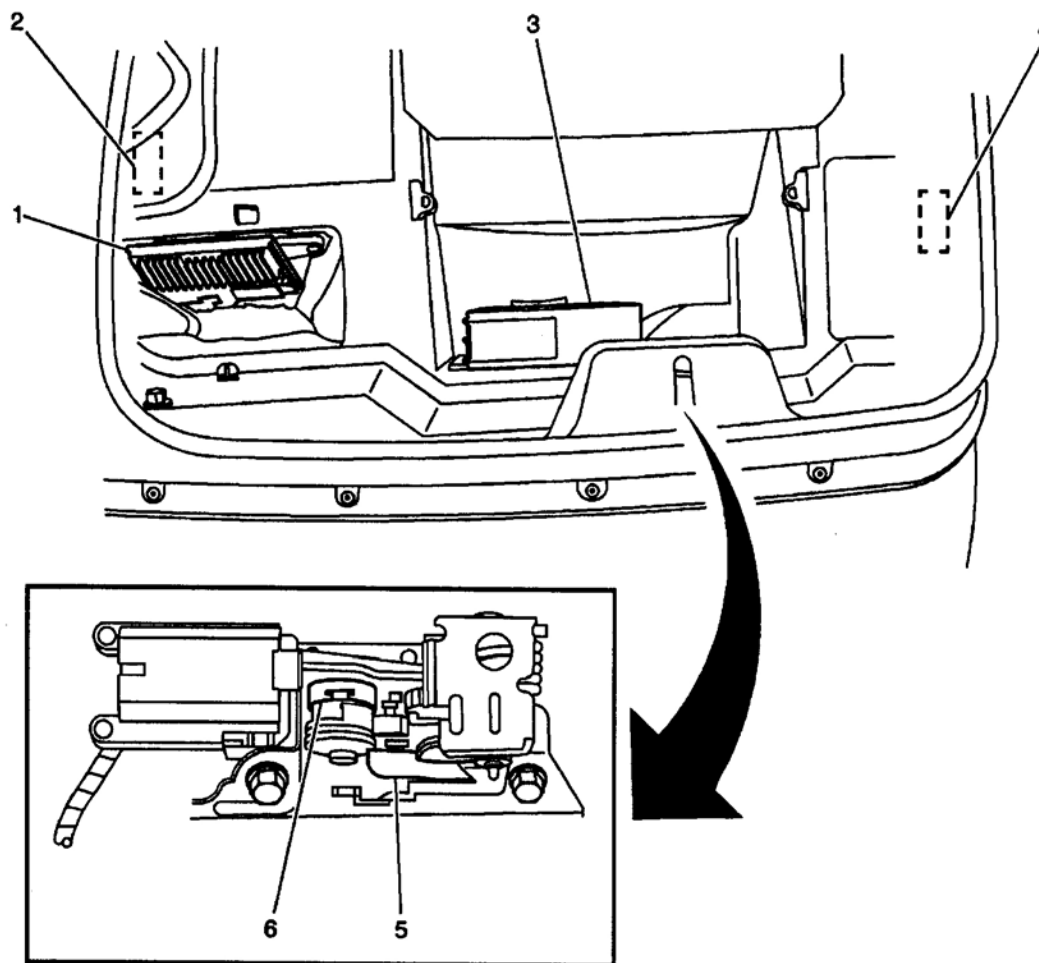

- (1) Electronic Suspension Control (ESC) Module
- (2) Rear Compartment Courtesy Lamp - Left
- (3) Remote Playback Device - CD Changer
- (4) Rear Compartment Courtesy Lamp - Right
- (5) Rear Compartment Lid Ajar Switch
- (6) Rear Compartment Lid Latch (Hardtop/Convertible)

G00260577

Fig. 24: Luggage Compartment
Courtesy of GENERAL MOTORS CORP.

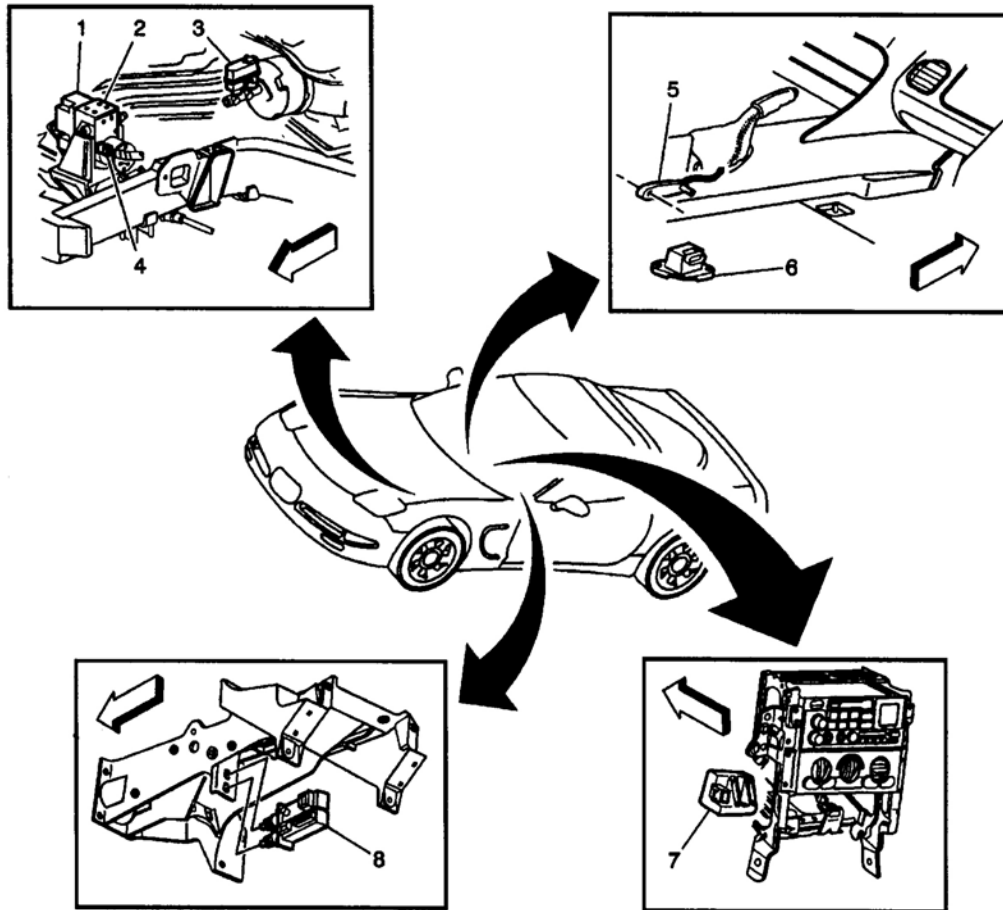

- (1) Electronic Brake Control Module (EBCM)
- (2) Brake Pressure Modular Valve (BPMV)
- (3) Brake Fluid Level Switch
- (4) Brake Fluid Pressure Sensor
- (5) Park Brake Switch
- (6) Lateral Accelerometer Sensor
- (7) Yaw Rate Sensor

- (8) Stoplamp Switch

G00260578

Fig. 25: Brake System Overview
Courtesy of GENERAL MOTORS CORP.

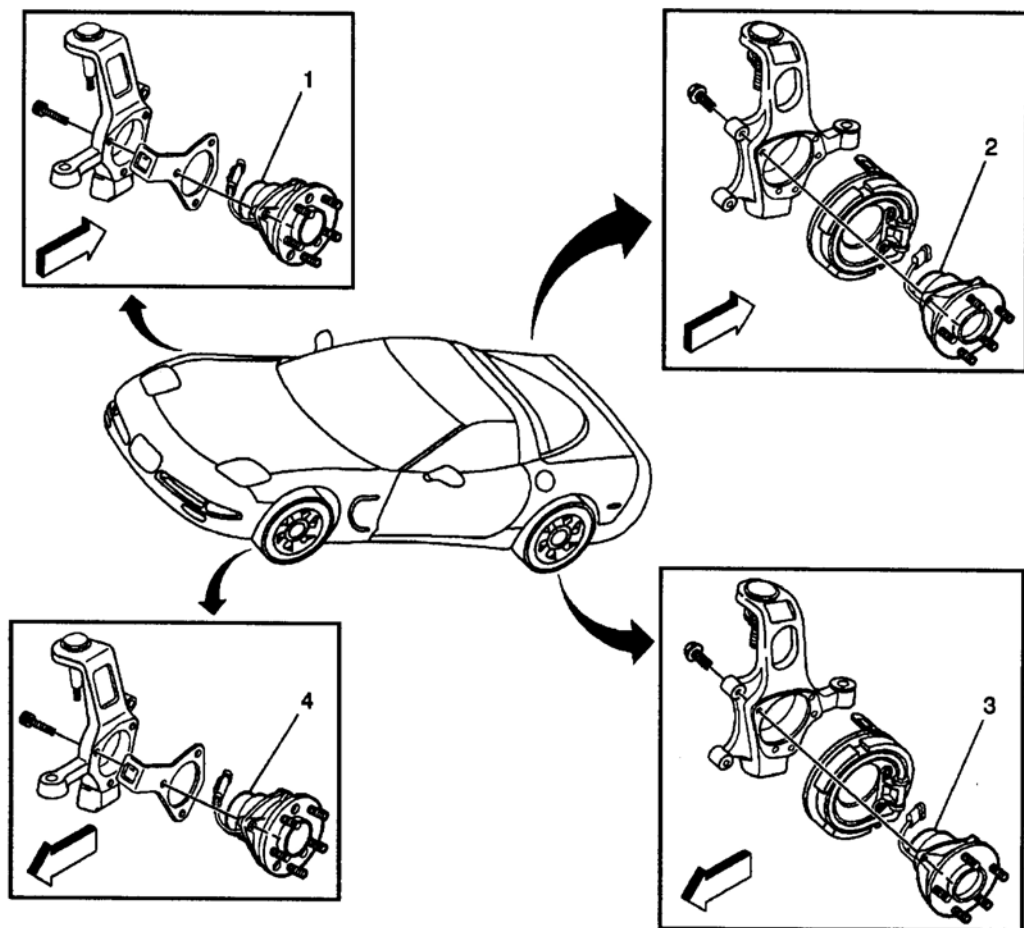

- (1) Wheel Speed Sensor (WSS) - RF
- (2) Wheel Speed Sensor (WSS) - RR
- (3) Wheel Speed Sensor (WSS) - LR
- (4) Wheel Speed Sensor (WSS) - LF

G00260580

Fig. 26: Wheel Speed Sensors
Courtesy of GENERAL MOTORS CORP.

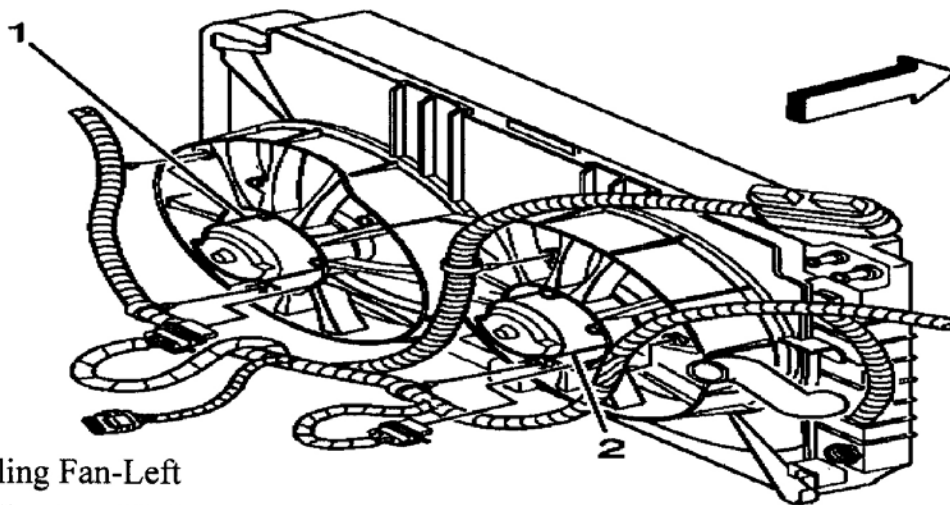

- (1) Cooling Fan-Left
- (2) Cooling Fan-Right

G00260581

Fig. 27: Front Of Engine Compartment
Courtesy of GENERAL MOTORS CORP.

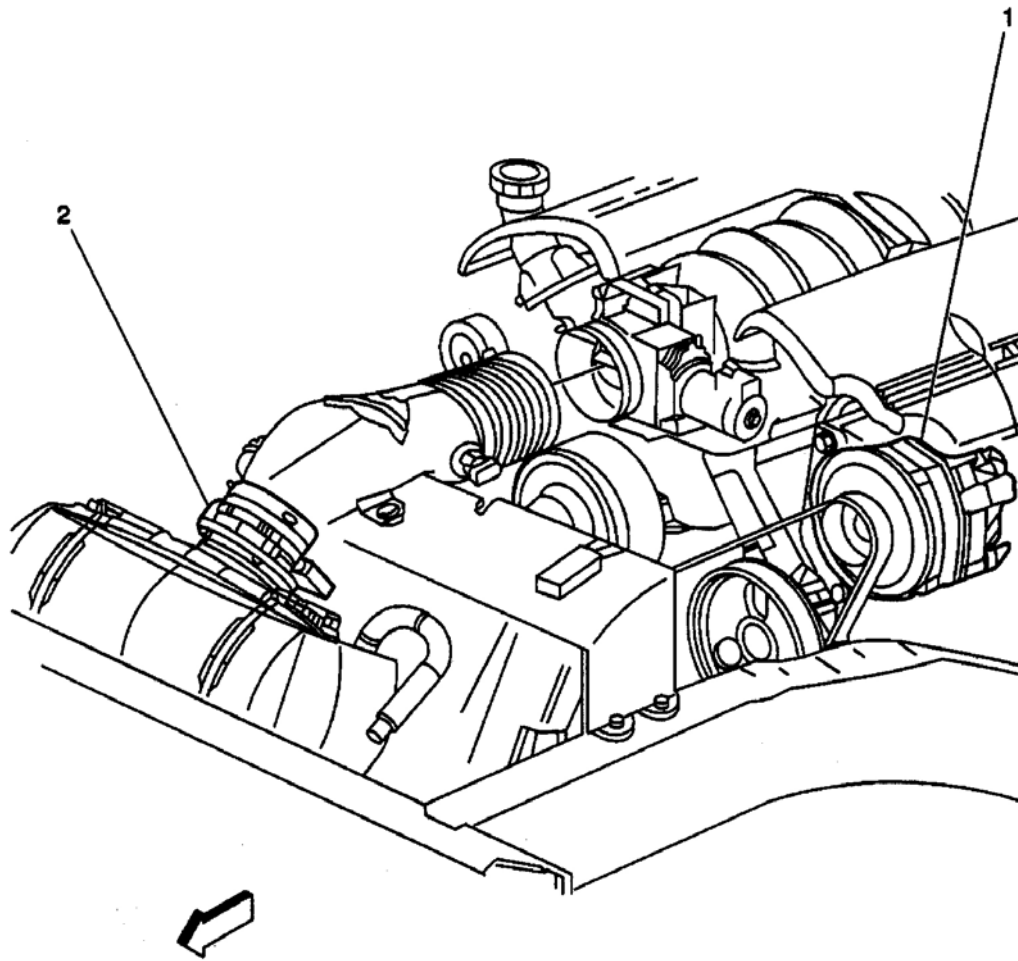

- (1) Generator
- (2) Mass Air Flow (MAF) Sensor

G00260582

Fig. 28: Front Of Engine Compartment
Courtesy of GENERAL MOTORS CORP.

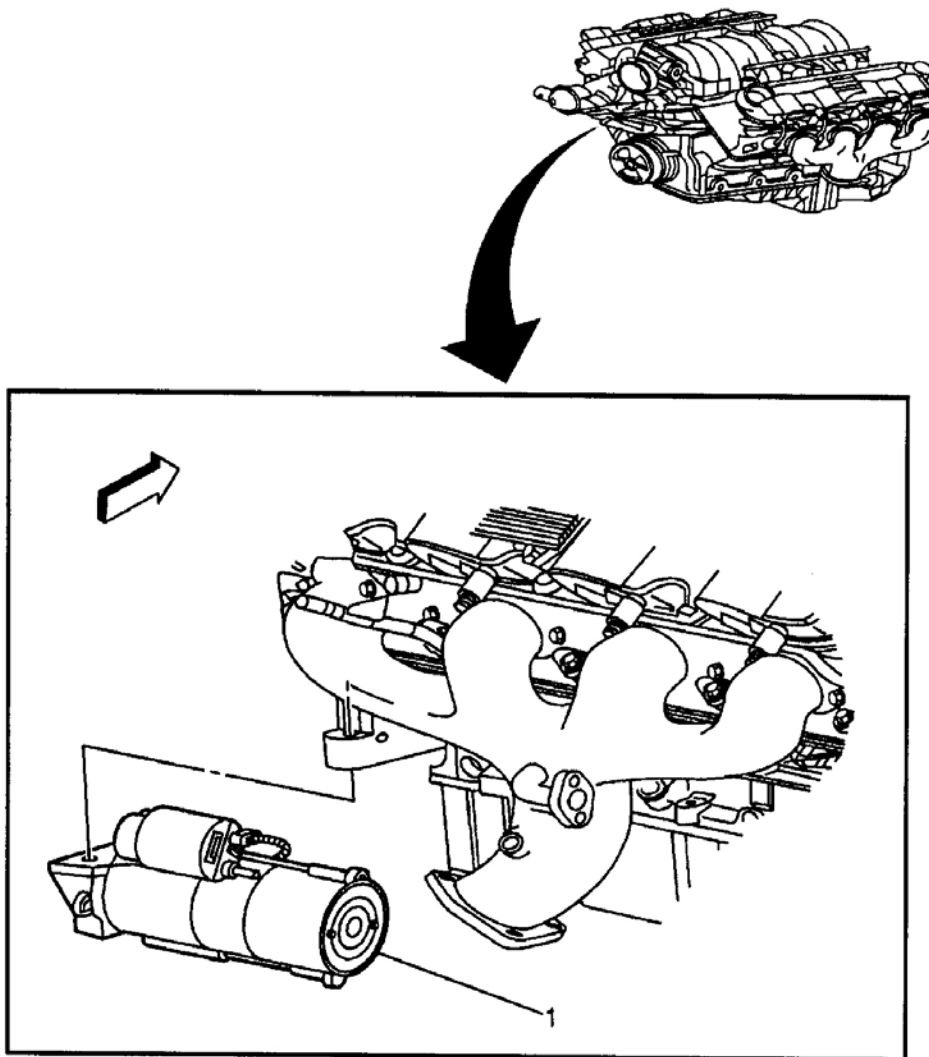

(1) Starter

G00260583

Fig. 29: Right Side Of Engine
Courtesy of GENERAL MOTORS CORP.

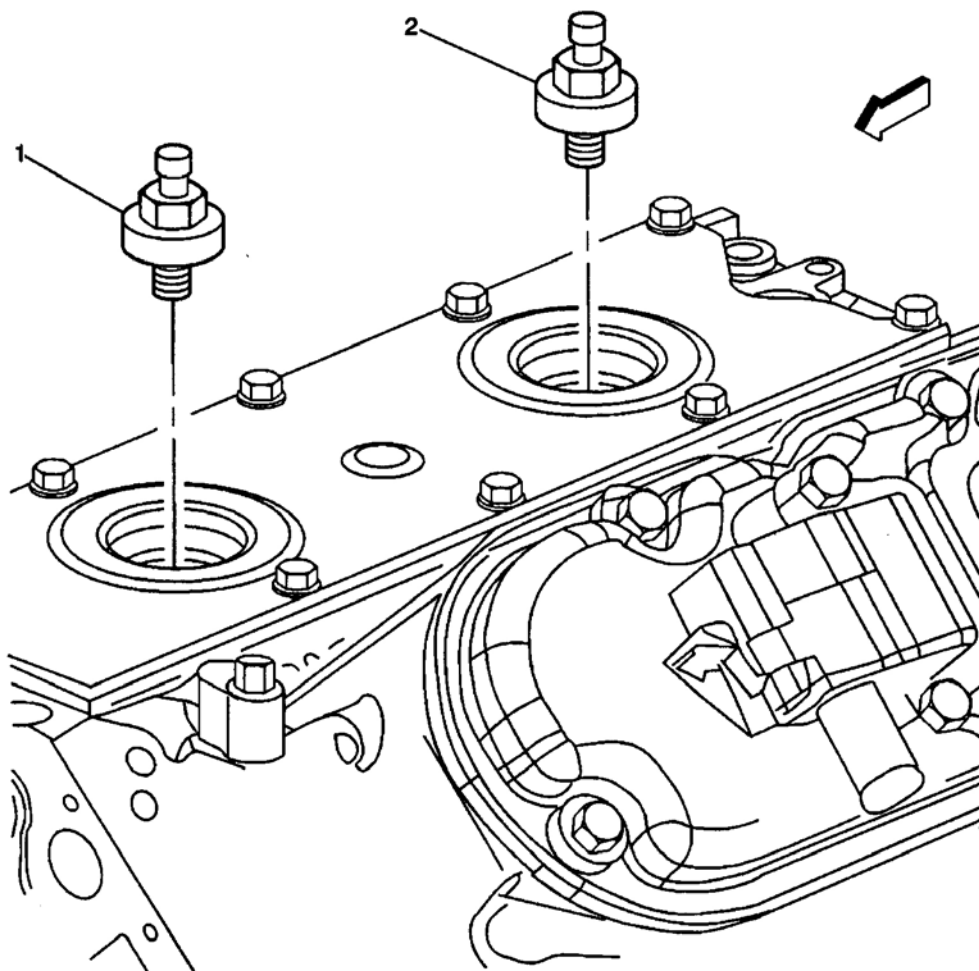

- (1) Knock Sensor (KS) 1
- (2) Knock Sensor (KS) 2

G00260584

Fig. 30: Below Engine Intake Manifold
Courtesy of GENERAL MOTORS CORP.

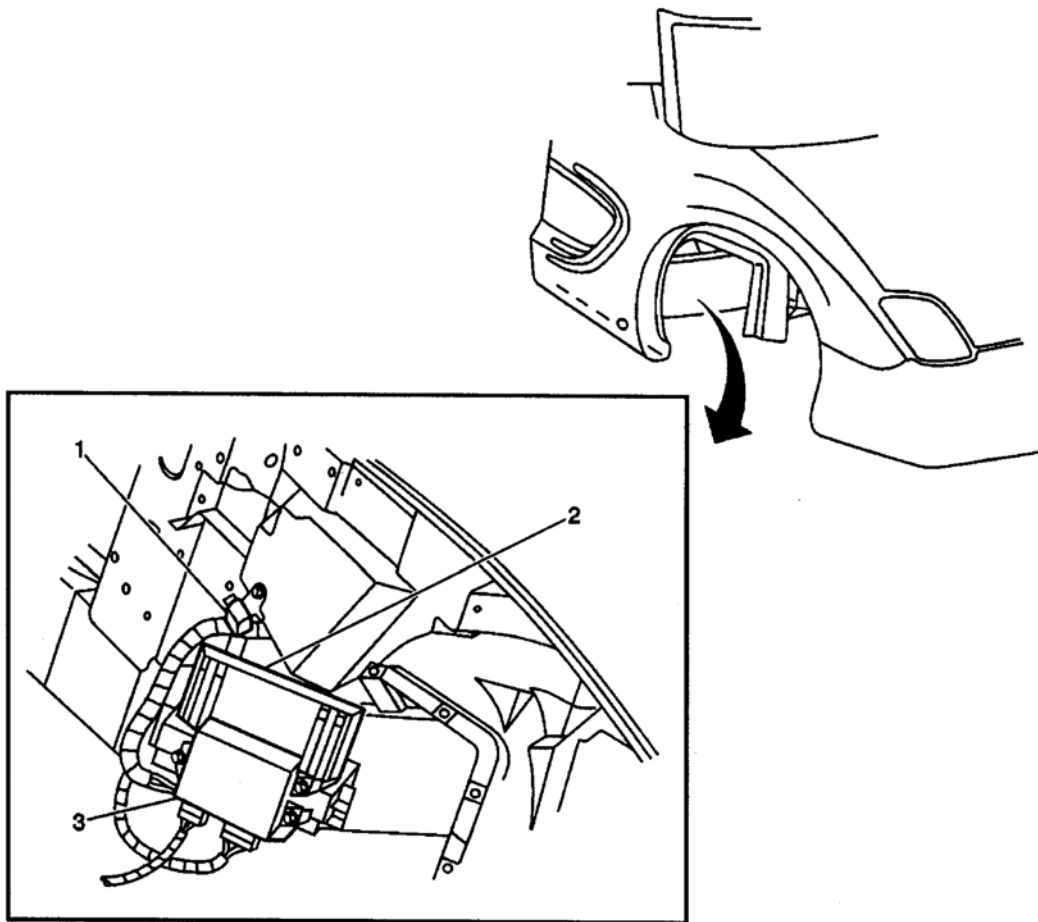

- (1) Secondary Air Injection (AIR) Solenoid
- (2) Powertrain Control Module (PCM)
- (3) Throttle Actuator Control (TAC) Module

G00260585

Fig. 31: Right Front Wheelwell
Courtesy of GENERAL MOTORS CORP.

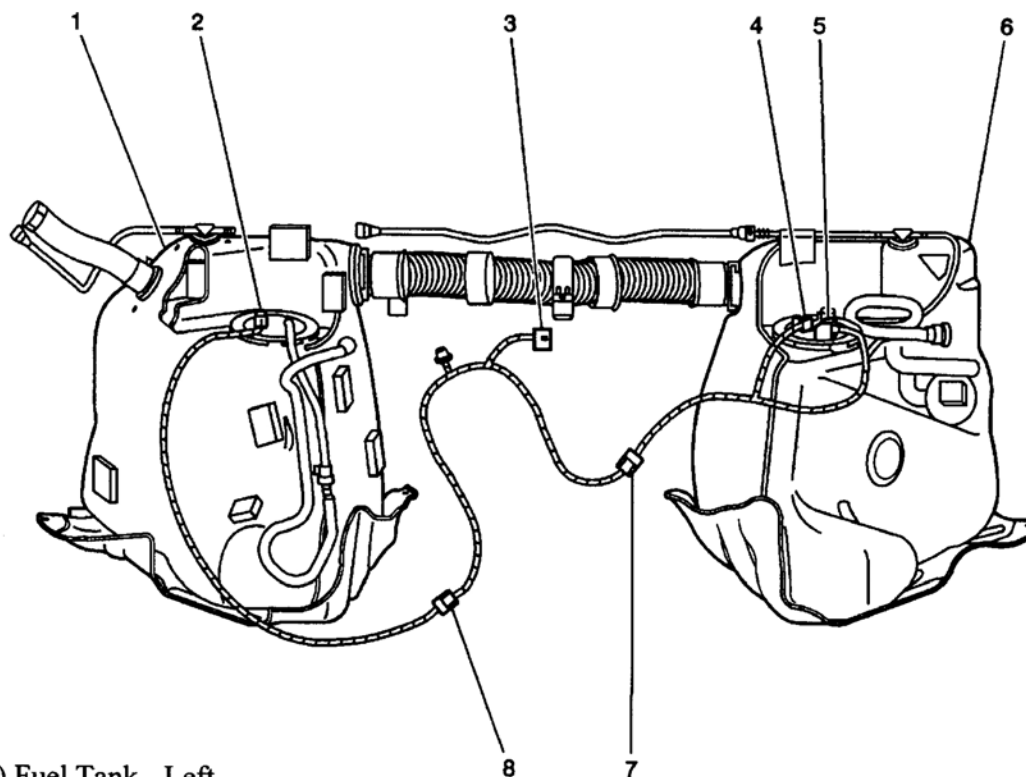

- (1) Fuel Tank - Left
- (2) Fuel Pump and Sender Assembly
- (3) C402
- (4) Fuel Tank Pressure (FTP) Sensor
- (5) Fuel Level Sensor - Right
- (6) Fuel Tank - Right
- (7) C414
- (8) C412

G00260586

Fig. 32: Fuel Tanks
Courtesy of GENERAL MOTORS CORP.

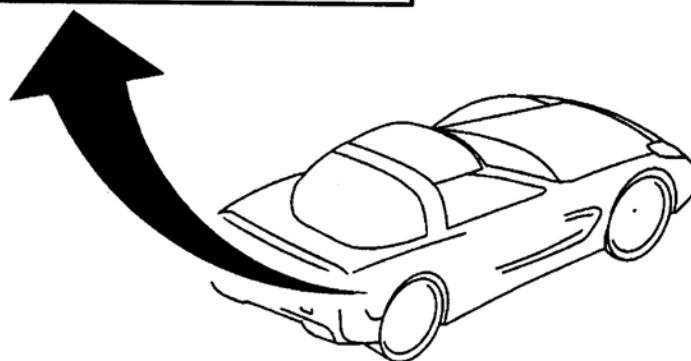
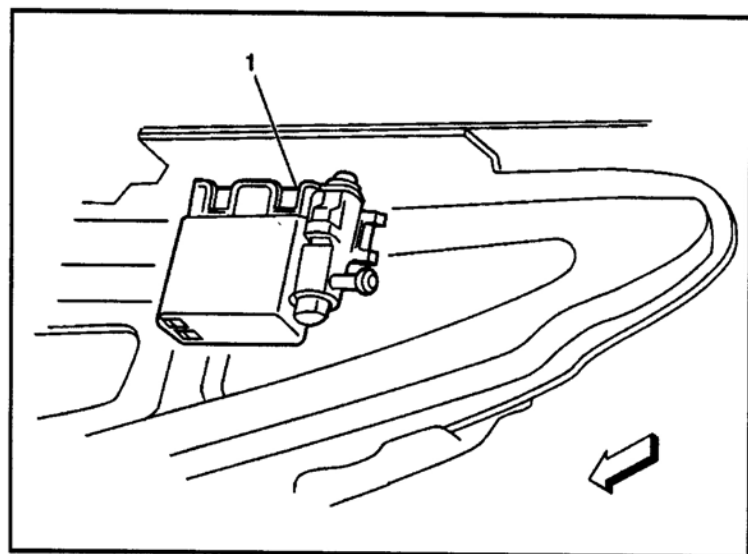

(1) Evaporative Emission (EVAP) Canister Vent Solenoid

G00260587

Fig. 33: Right Side Of Rear Compartment
Courtesy of GENERAL MOTORS CORP.

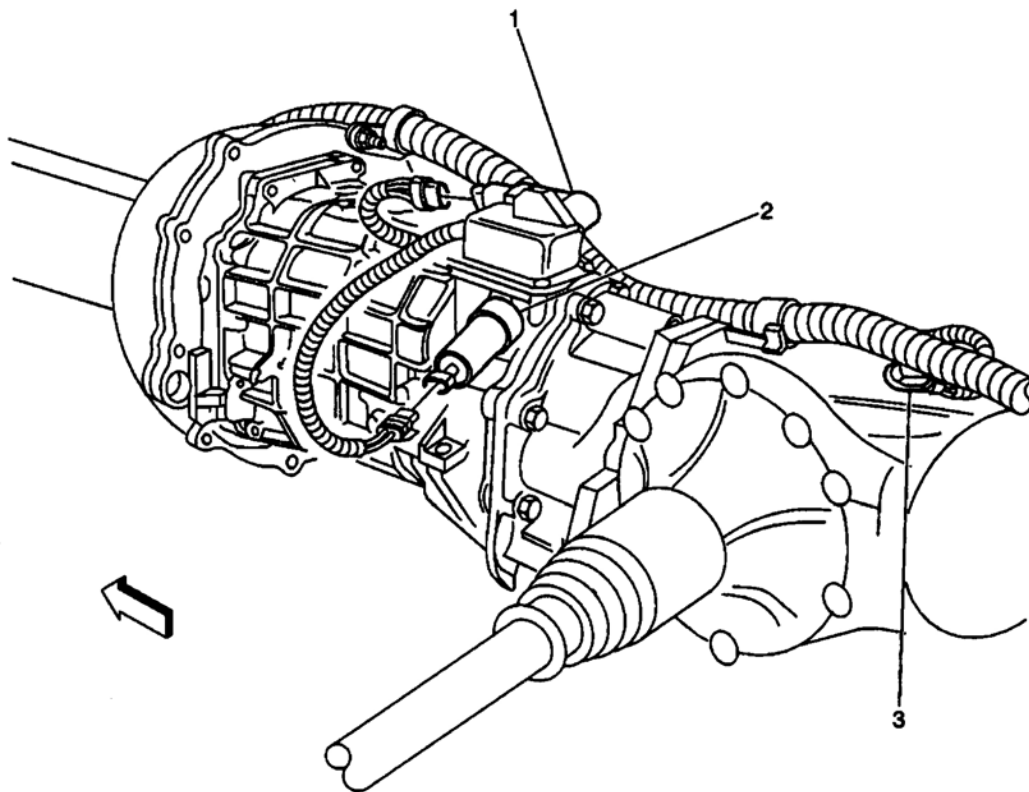

- (1) Reverse Inhibit Solenoid
- (2) Skip Shift Solenoid
- (3) Vehicle Speed Sensor (VSS)

G00260588

Fig. 34: Manual Transmission
Courtesy of GENERAL MOTORS CORP.

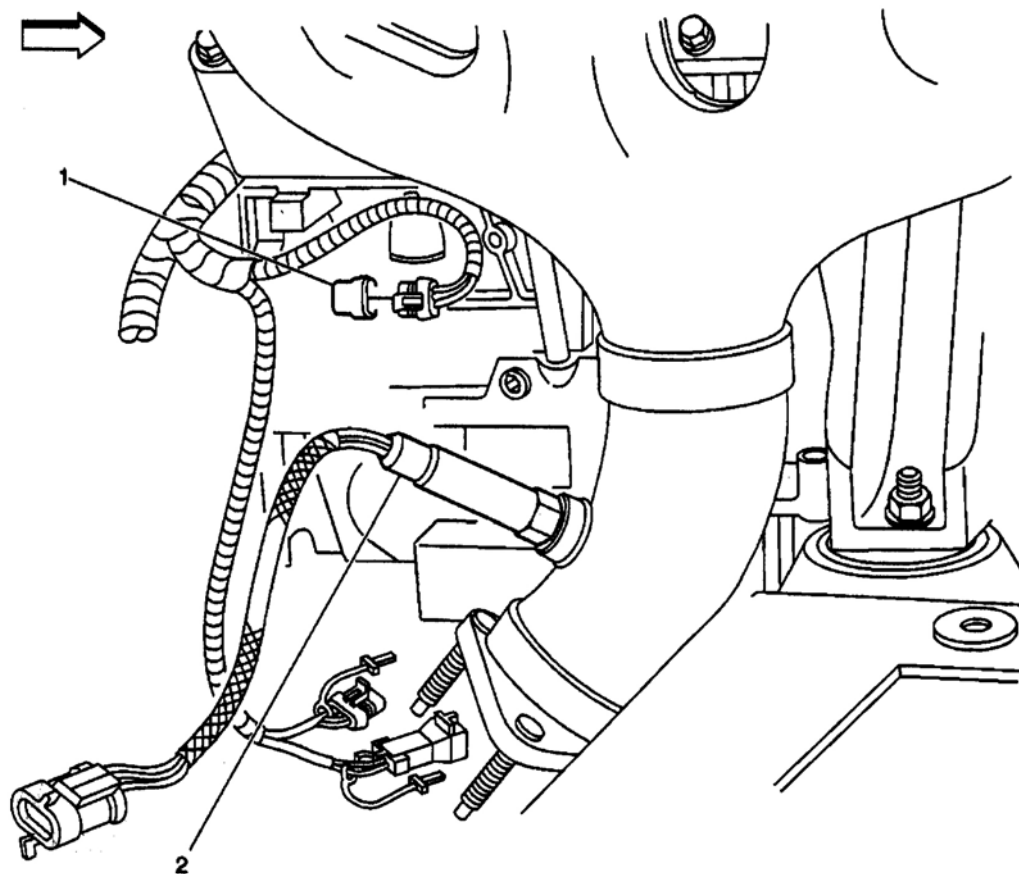

- (1) Crankshaft Position (CKP) Sensor
(2) Heated Oxygen Sensor (HO2S) Bank 2 Sensor 1

G00260590

Fig. 35: Lower Right Side Of Engine
Courtesy of GENERAL MOTORS CORP.

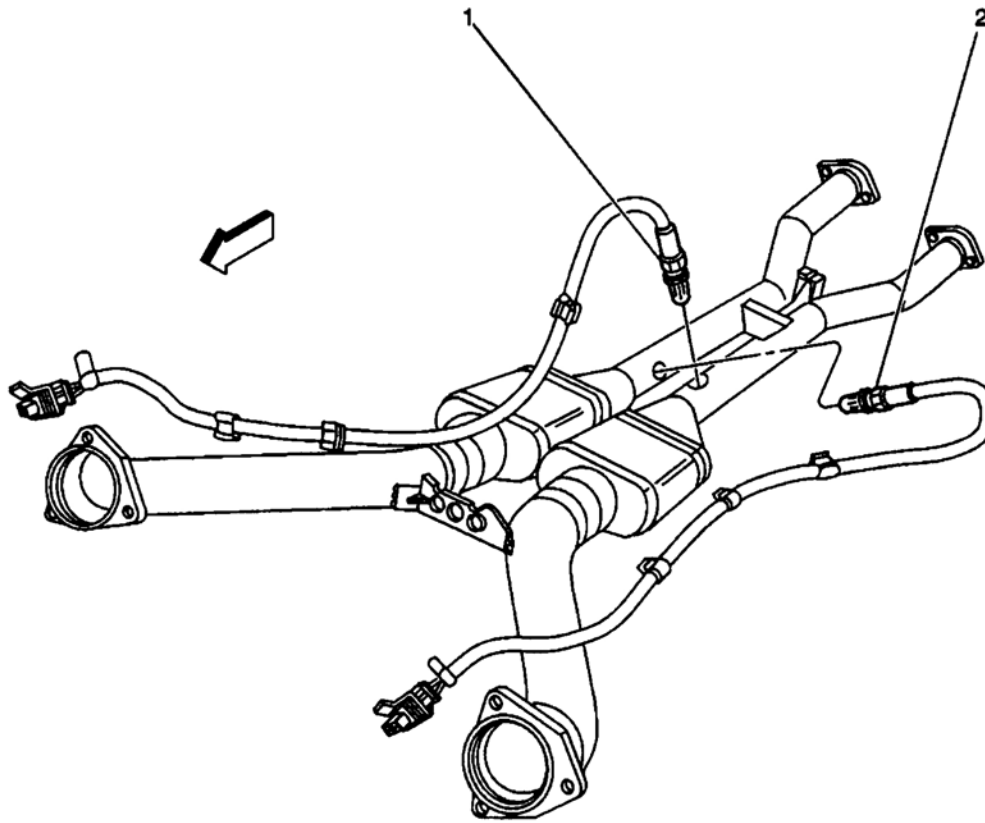

- (1) Heated Oxygen Sensor (HO2S) Bank 1 Sensor 2
(2) Heated Oxygen Sensor (HO2S) Bank 2 Sensor 2

G00260591

Fig. 36: Exhaust System
Courtesy of GENERAL MOTORS CORP.

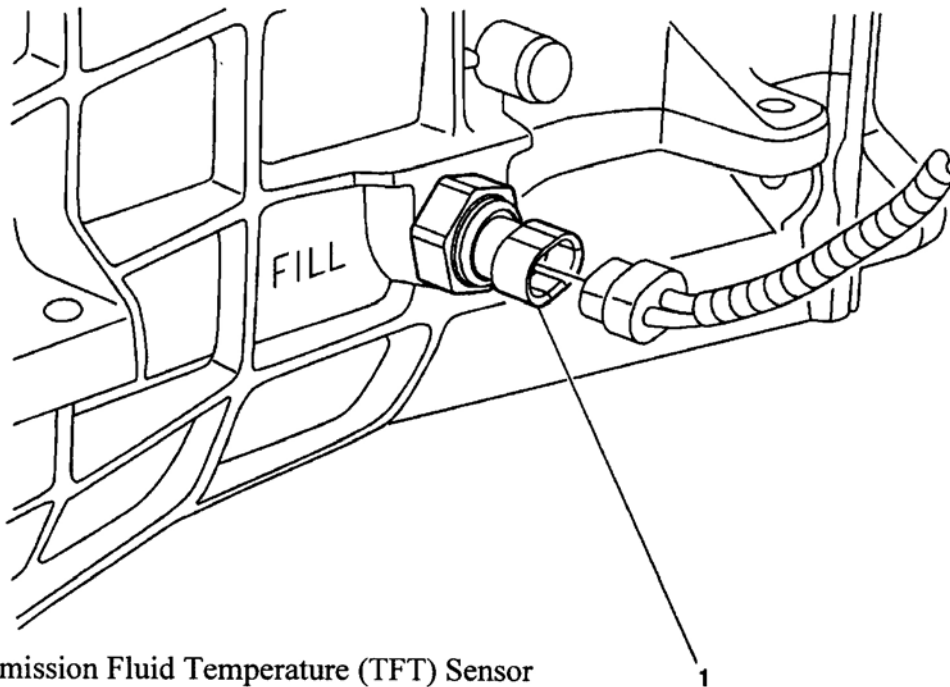

(1) Transmission Fluid Temperature (TFT) Sensor

G00260593

Fig. 37: Left Side Of Transmission
Courtesy of GENERAL MOTORS CORP.

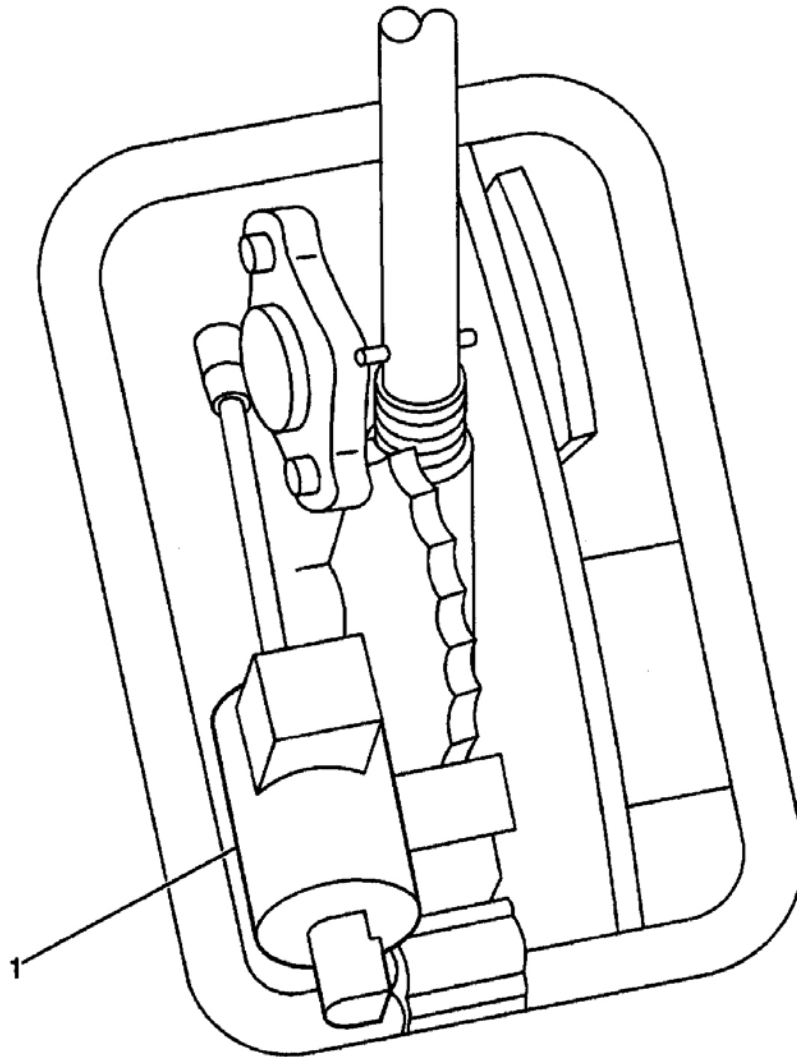

(1) A/T Shift Lock Control Solenoid

G00260594

Fig. 38: Center Console
Courtesy of GENERAL MOTORS CORP.

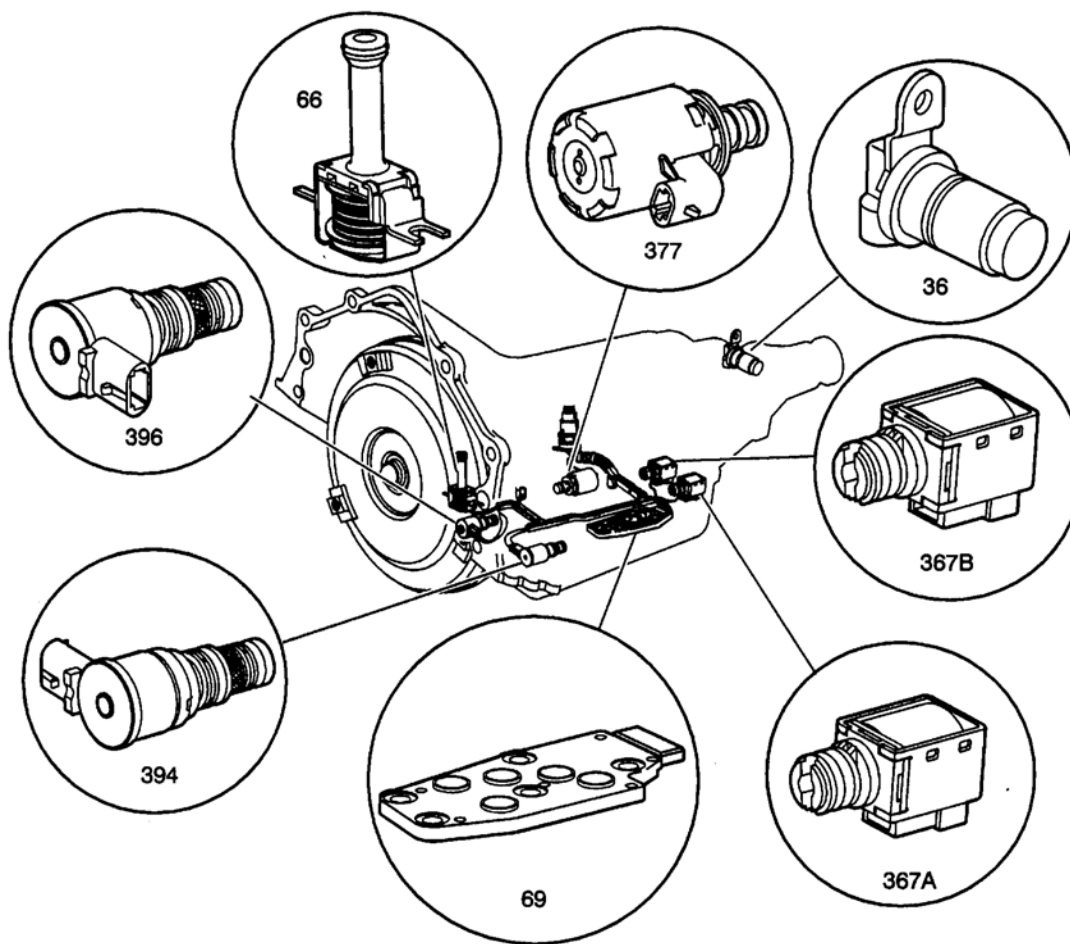

- (36) Vehicle Speed Sensor (VSS)
- (66) Torque Converter Clutch (TCC) Solenoid Valve
- (69) Automatic Transmission Fluid Pressure (TFP) Manual Valve Position Switch
- (367a) 1-2 Shift Solenoid (SS) Valve
- (367b) 2-3 Shift Solenoid (SS) Valve
- (377) Pressure Control (PC) Solenoid Valve
- (394) 3-2 Shift Solenoid (SS) Valve Assembly
- (396) Torque Converter Clutch Pulse Width Modulation (TCC PWM) Solenoid Valve

G00260595

Fig. 39: Transmission Overview
Courtesy of GENERAL MOTORS CORP.

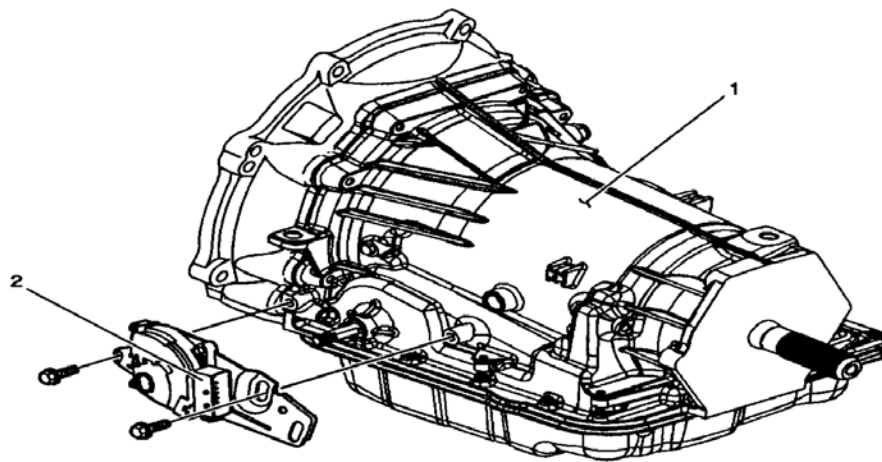

- (1) Automatic Transmission 4L60-E
- (2) PNP Switch

G00260596

Fig. 40: Left Side Of Automatic Transmission
Courtesy of GENERAL MOTORS CORP.

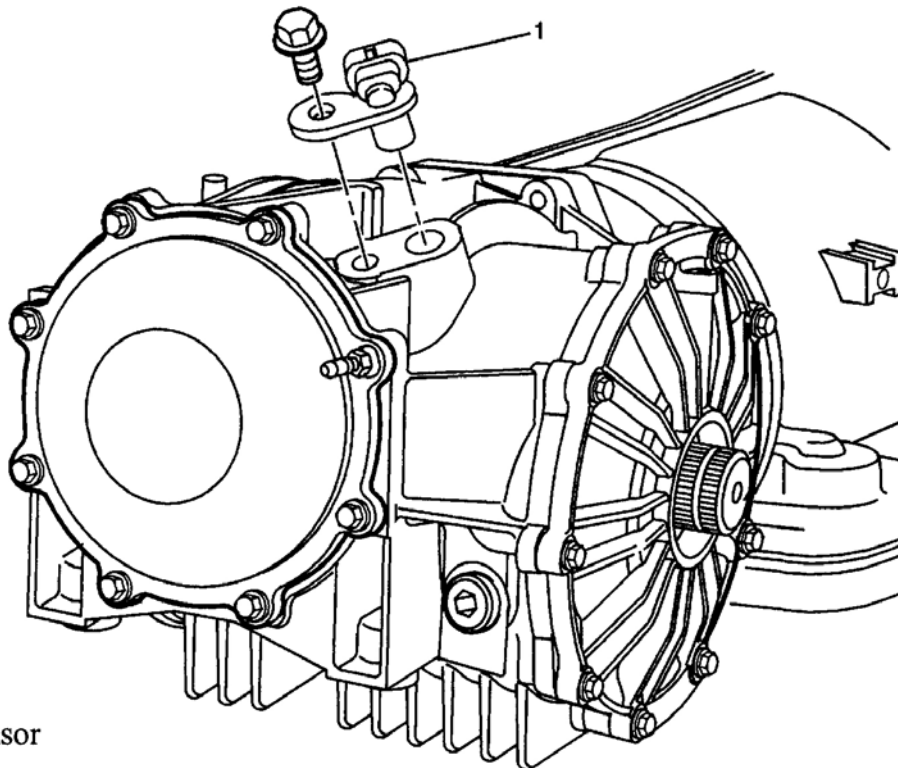

- (1) VSS Sensor

G00260597

Fig. 41: Top Right Of Differential
Courtesy of GENERAL MOTORS CORP.

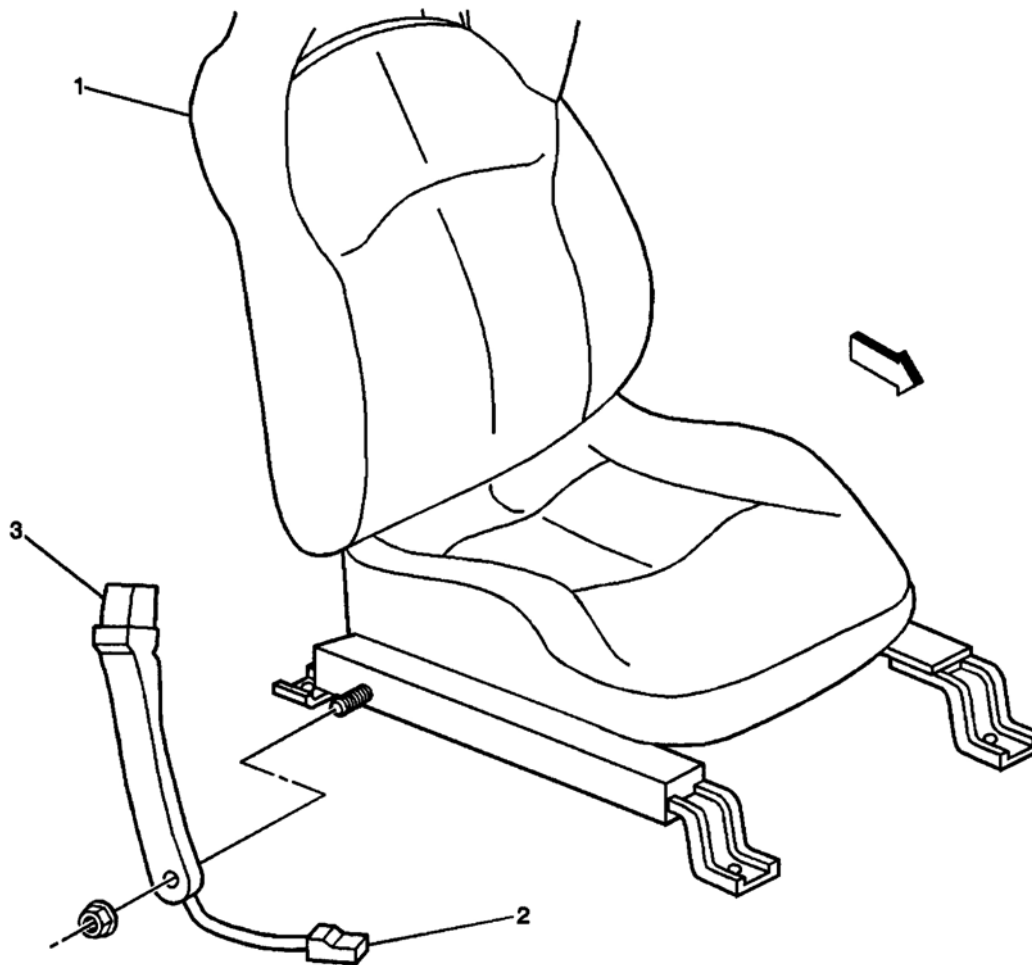

- (1) Drivers Seat
- (2) Seat Belt Switch--Driver Connector
- (3) Seat Belt Buckle--Driver

G00260598

Fig. 42: Drivers Seat
Courtesy of GENERAL MOTORS CORP.

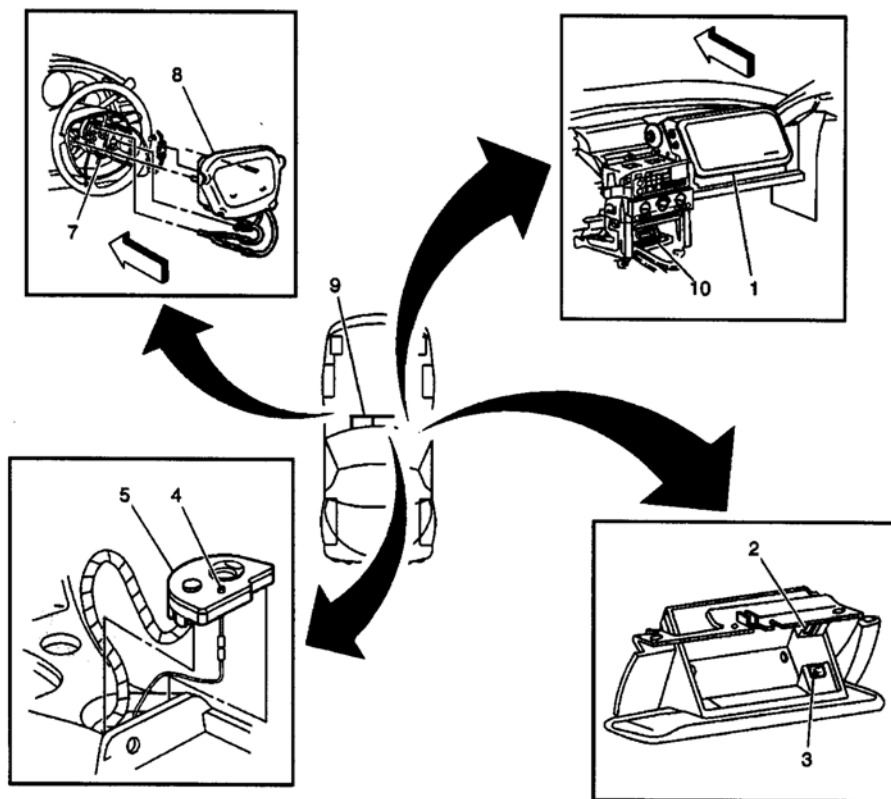

- (9) SIR Wiring Harness
- (1) Inflatable Restraint IP Module (10) Inflatable Restraint Sensing and Diagnostic Module (SDM)
- (2) IP Compartment Lamp
- (3) Inflatable Restraint IP Module Disable Switch
- (4) Inflatable Restraint IP Module Disable Switch LED
- (5) Traction/Suspension Control Switch
- (7) Inflatable Restraint Steering Wheel Module Coil
- (8) Inflatable Restraint Steering Wheel Module

G00260599

Fig. 43: SIR System Overview
Courtesy of GENERAL MOTORS CORP.

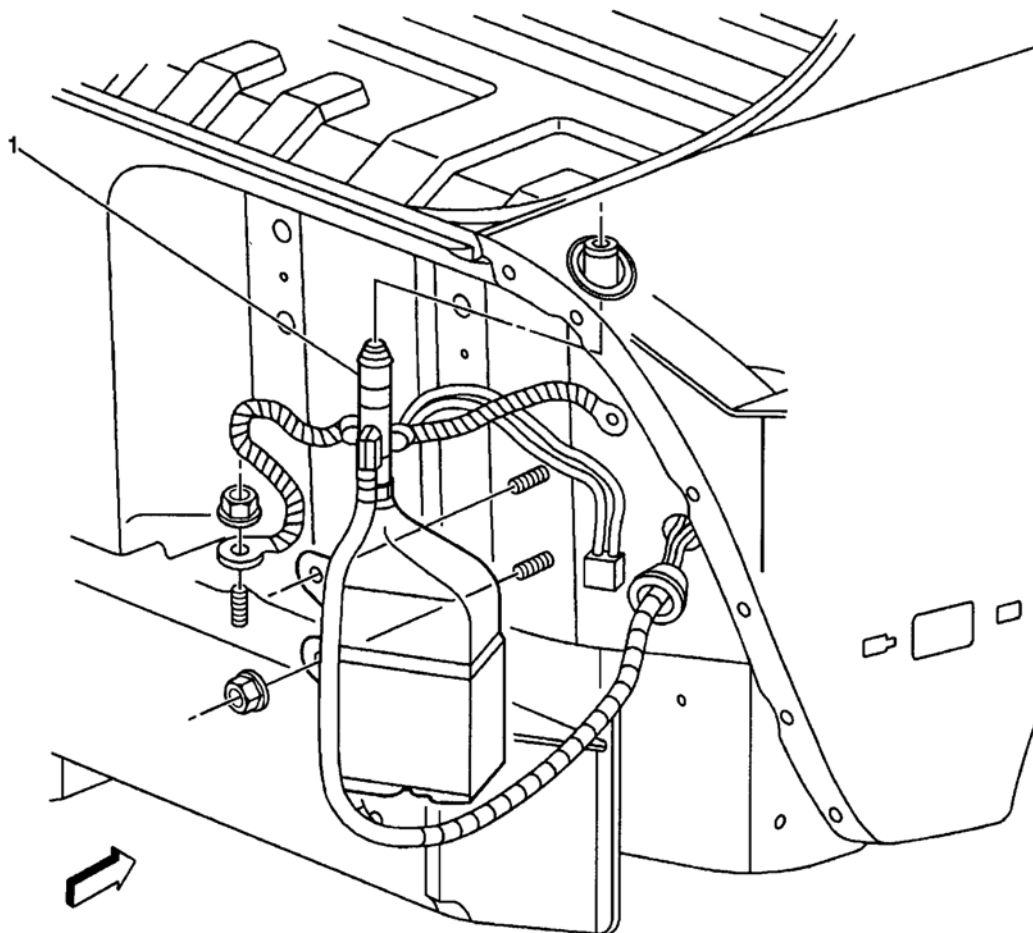

(1) Radio Power Antenna (Convertible)

G00260601

Fig. 44: Right Rear Of Vehicle
Courtesy of GENERAL MOTORS CORP.

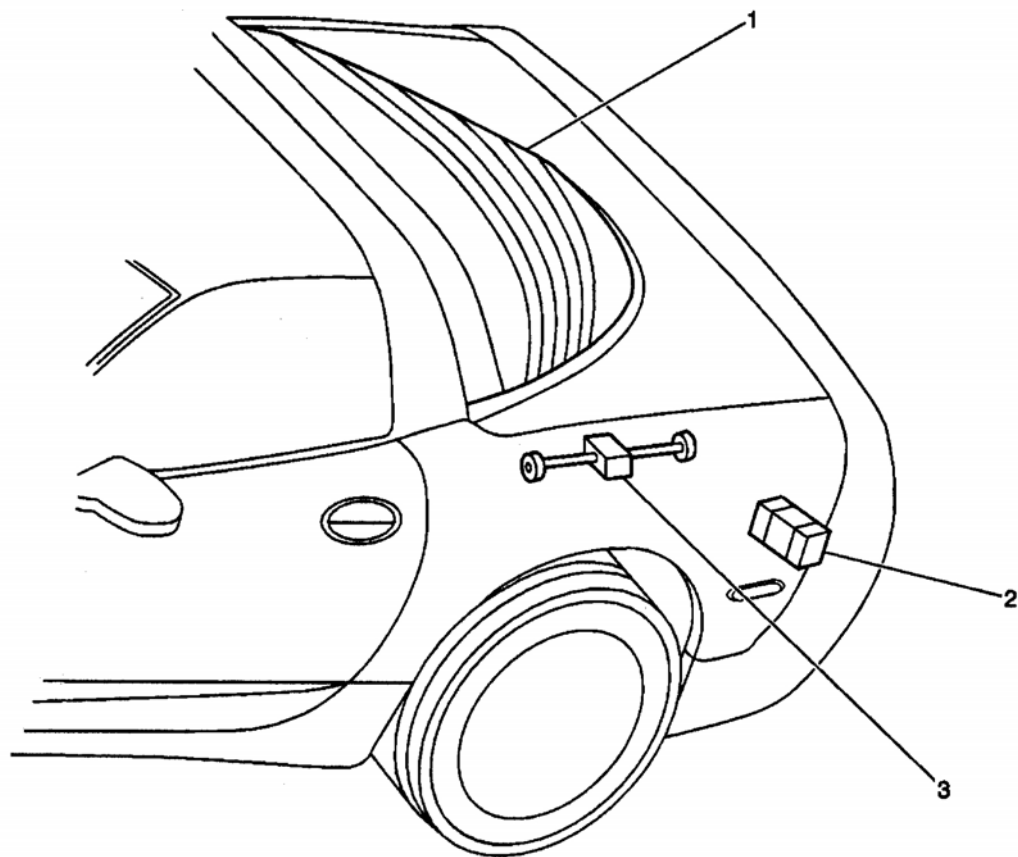

- (1) Defogger Grid
- (2) Electronic Suspension Control (ESC) Module
- (3) Remote Control Door Lock Receiver (RCDLR)

G00260602

Fig. 45: Left Rear Of Vehicle
Courtesy of GENERAL MOTORS CORP.

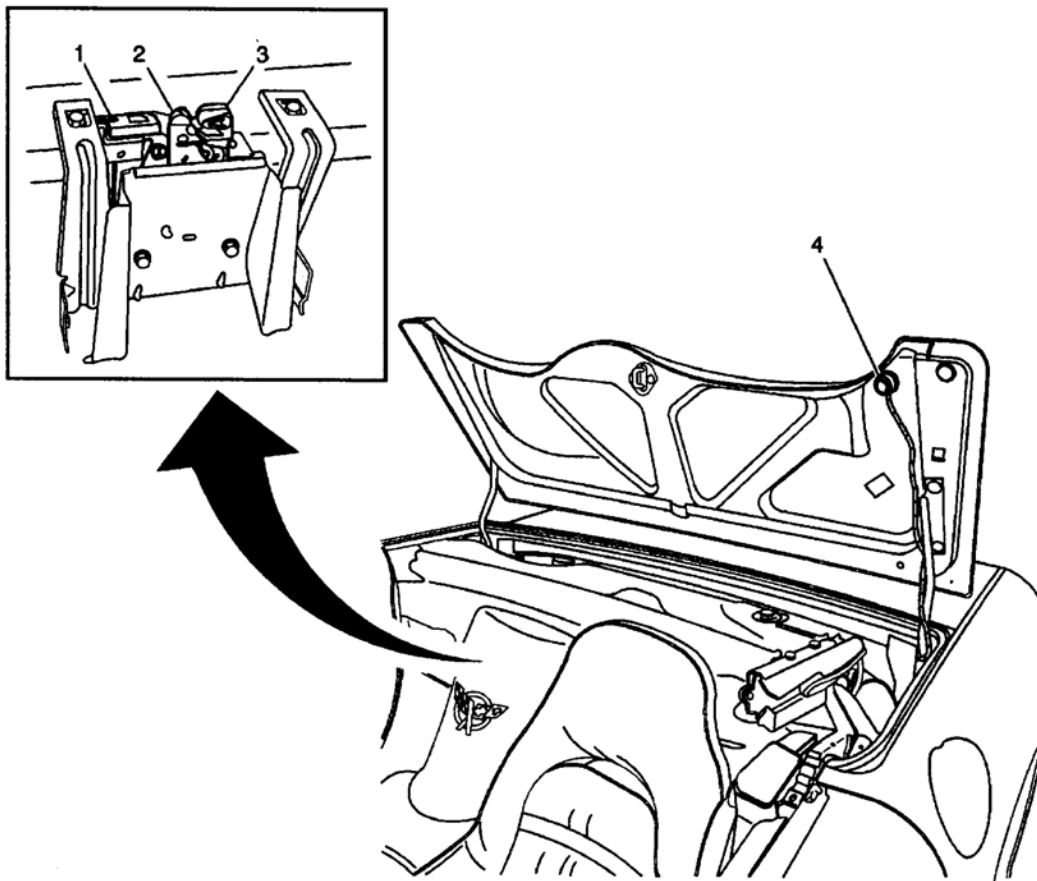

- (1) Folding Top Actuator
- (2) Folding Top Ajar Indicator Switch
- (3) Folding Top Lid Latch
- (4) Folding Top Release Switch

G00260607

Fig. 46: Folding Top
Courtesy of GENERAL MOTORS CORP.

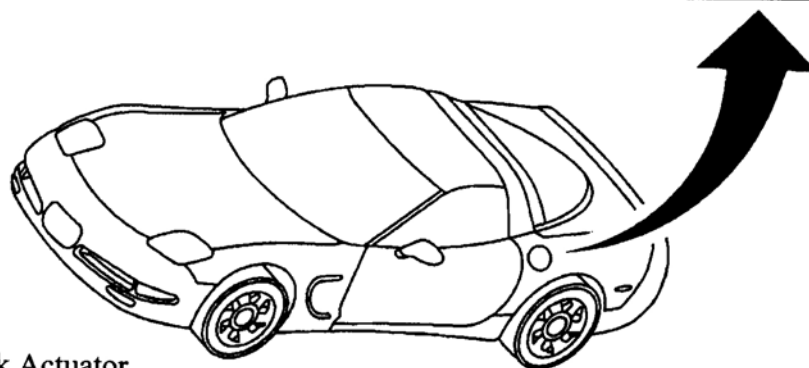
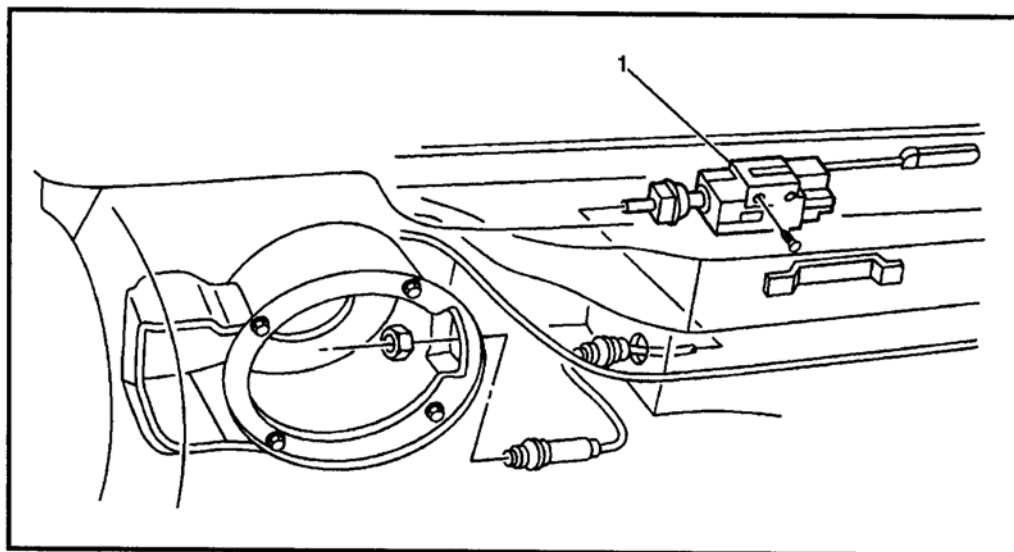

(1) Fuel Door Lock Actuator

G00260609

Fig. 47: Left Rear Side Of Vehicle
Courtesy of GENERAL MOTORS CORP.

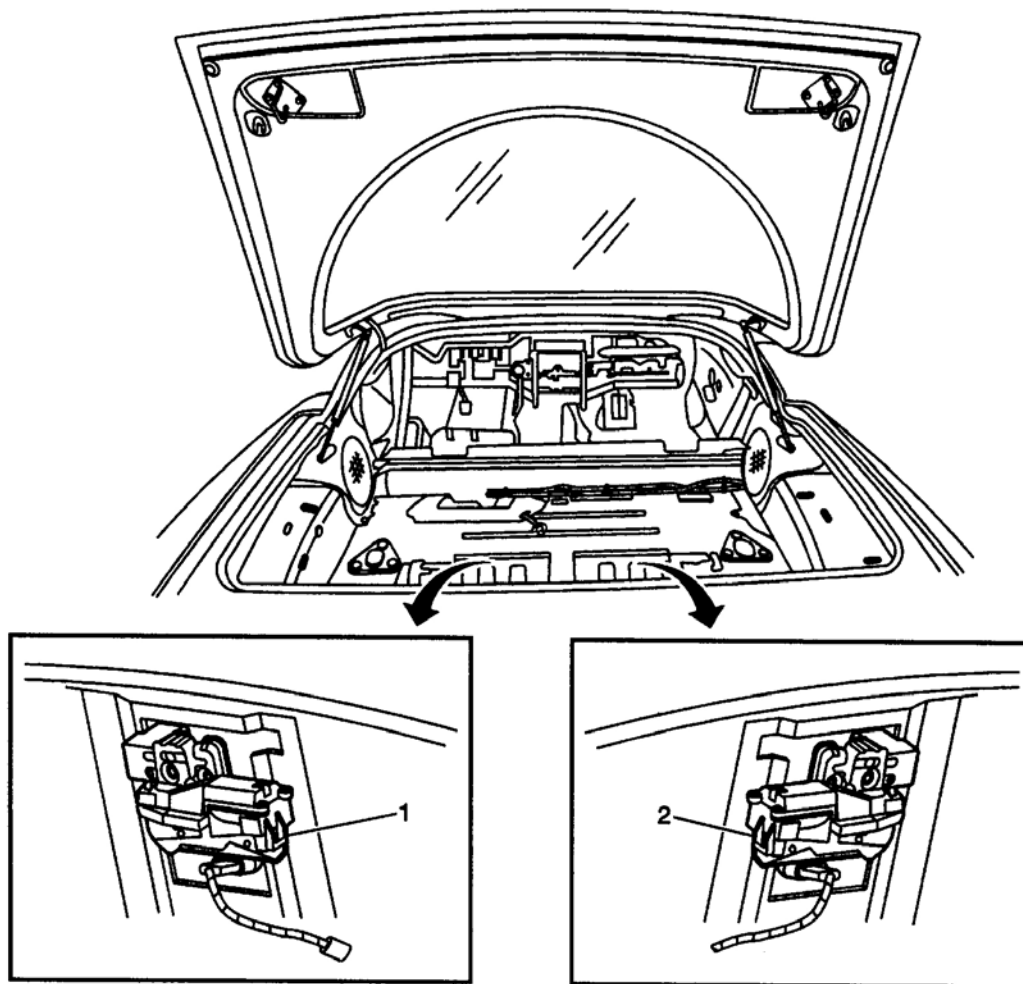

- (1) Rear Compartment Lid Latch -- Left
(2) Rear Compartment Lid Latch -- Right

G00260610

Fig. 48: Rear Compartment (Coupe)
Courtesy of GENERAL MOTORS CORP.

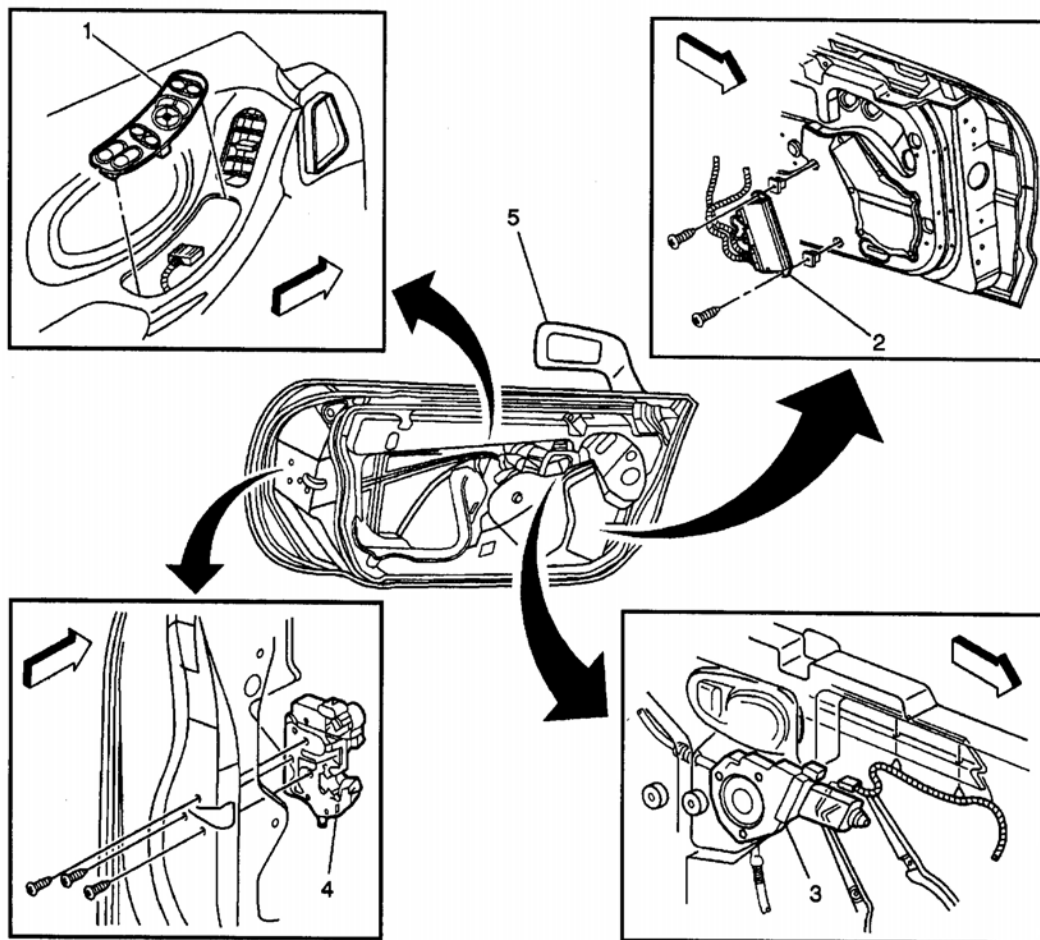

- (1) Door Switch - Driver
- (2) Driver Door Module (DDM)
- (3) Window Motor - Driver
- (4) Door Latch - Driver
- (5) Outside Rearview Mirror - Driver

G00260613

Fig. 49: Power Door System Overview
Courtesy of GENERAL MOTORS CORP.

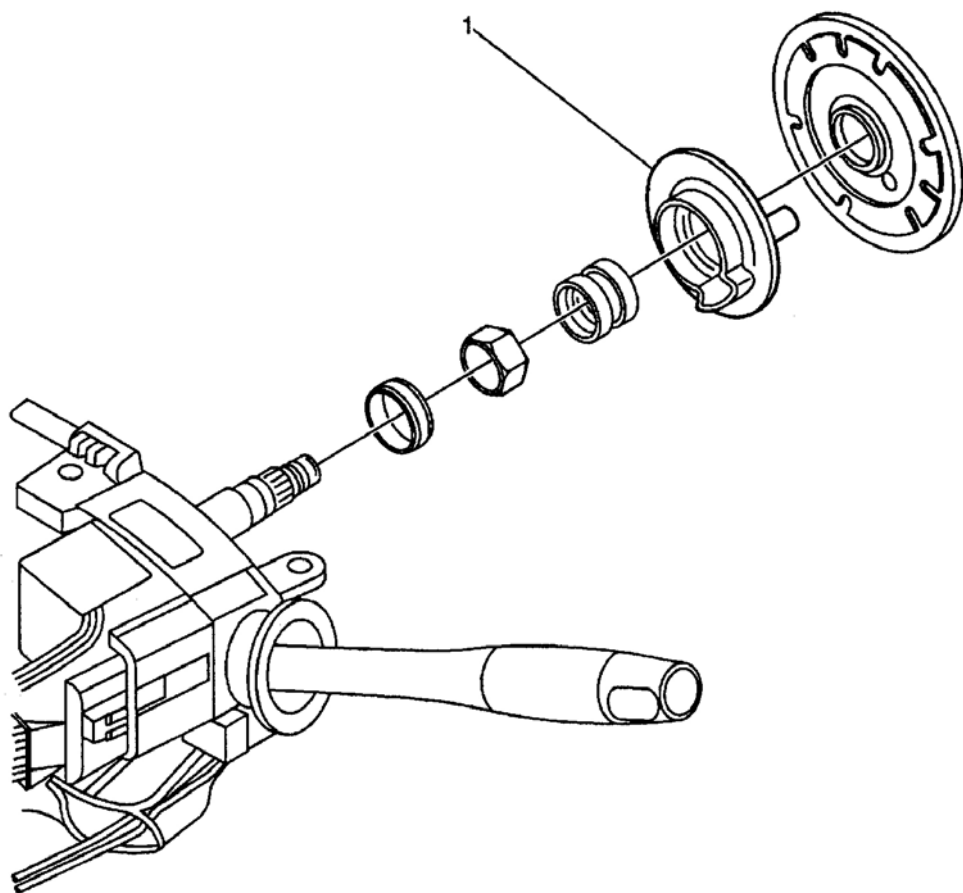

(1) Brush - Horn Slip Ring

G00260615

Fig. 50: Top Of Steering Column
Courtesy of GENERAL MOTORS CORP.

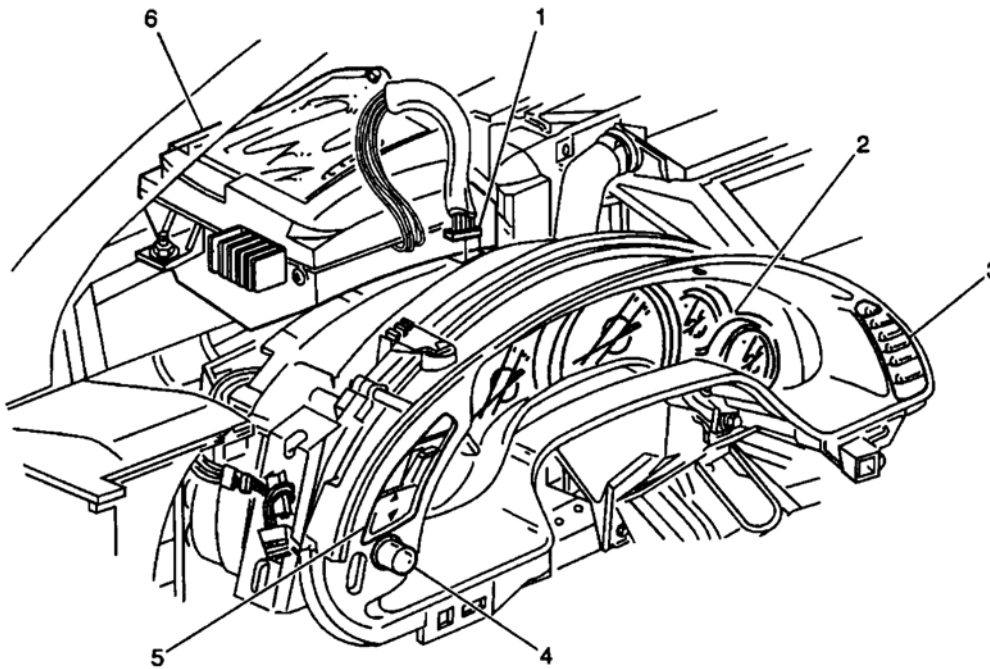

- (1) Heads Up Display (HUD) Connector
- (2) Instrument Panel Cluster (IPC)
- (3) Driver Information Center (DIC) Switch-Right
- (4) Dimmer Switch
- (5) Heads Up Display (HUD) Switch
- (6) Heads Up Display (HUD)

G00260616

Fig. 51: Left Side Of Dash
Courtesy of GENERAL MOTORS CORP.

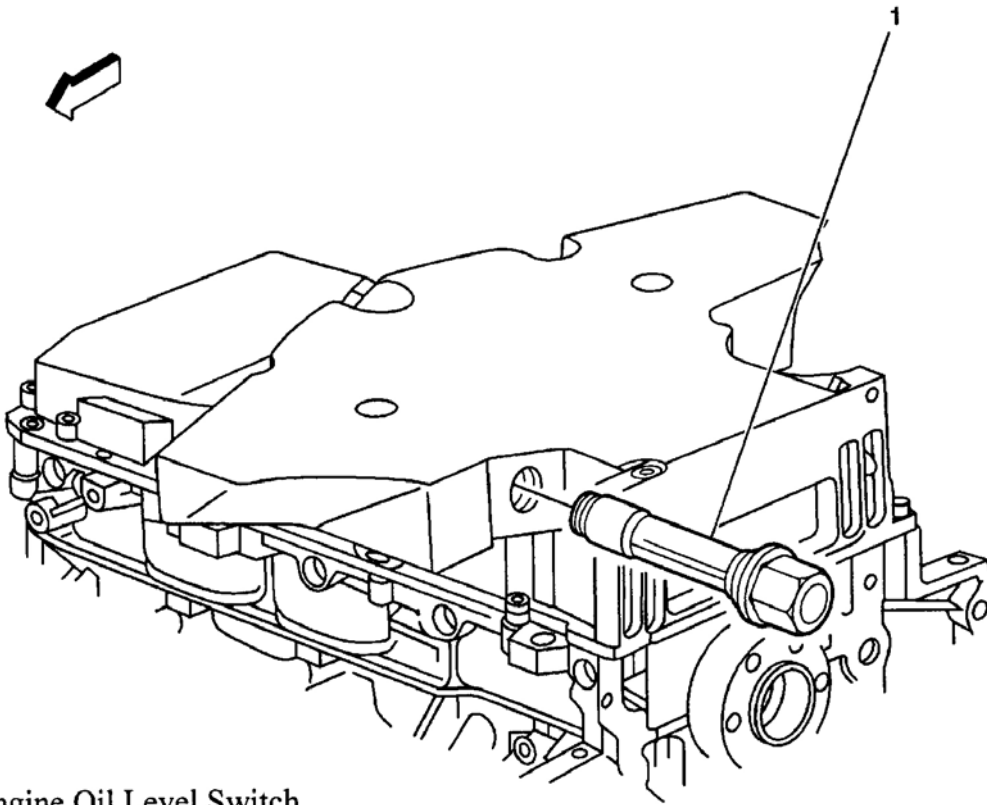

(1) Engine Oil Level Switch

G00260617

Fig. 52: Engine Oil Level Switch
Courtesy of GENERAL MOTORS CORP.

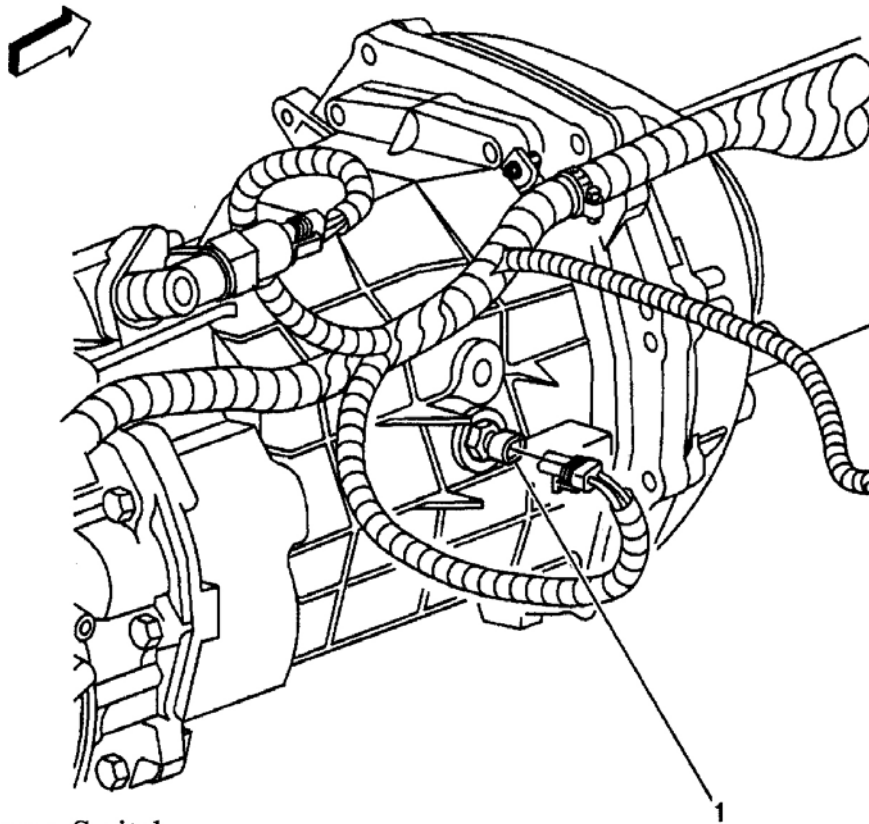

(1) Backup Lamp Switch

G00260623

Fig. 53: Right Side Of Transmission
Courtesy of GENERAL MOTORS CORP.

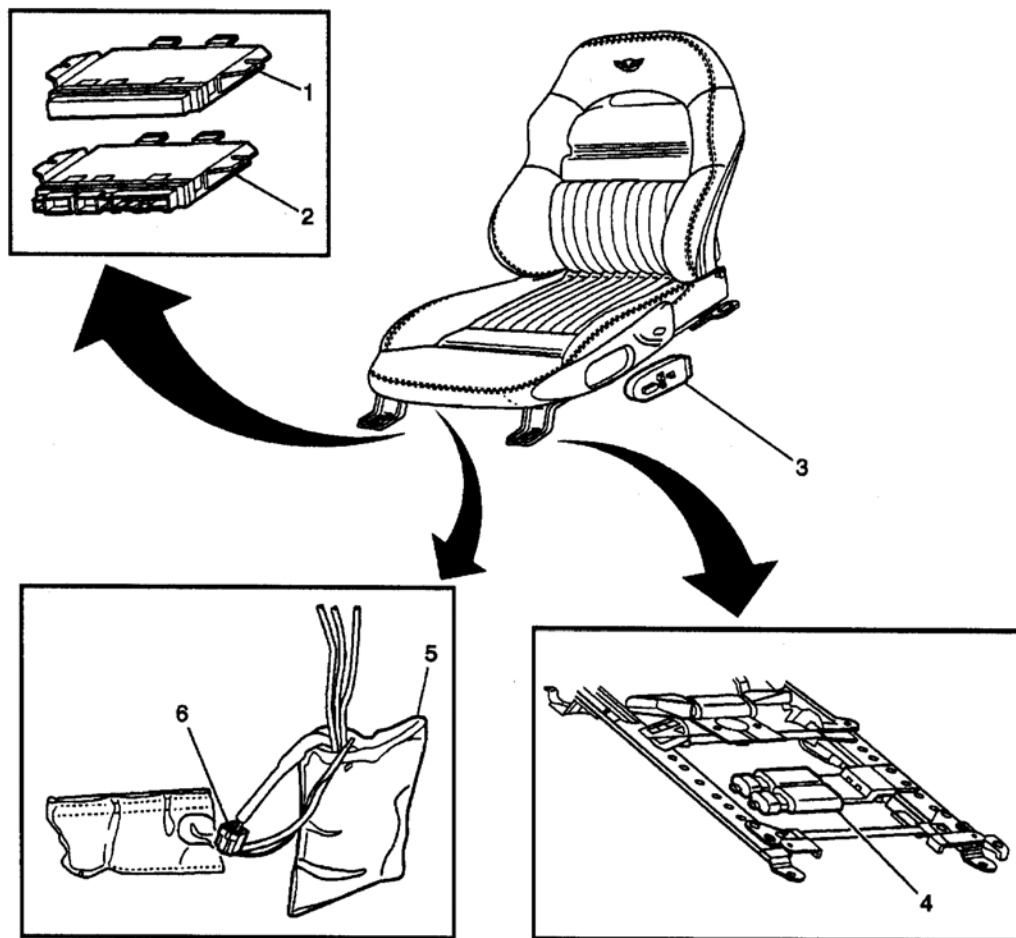

- (1) Seat Relay Center - Driver
- (2) Seat Control Module (SCM) - Driver
- (3) Seat Adjuster Switch - Driver
- (4) Seat Lower Motor - Driver
- (5) Seat Pump - Driver
- (6) Seat Pump Connector - Driver

G00260626

Fig. 54: Power Seat System Overview
Courtesy of GENERAL MOTORS CORP.

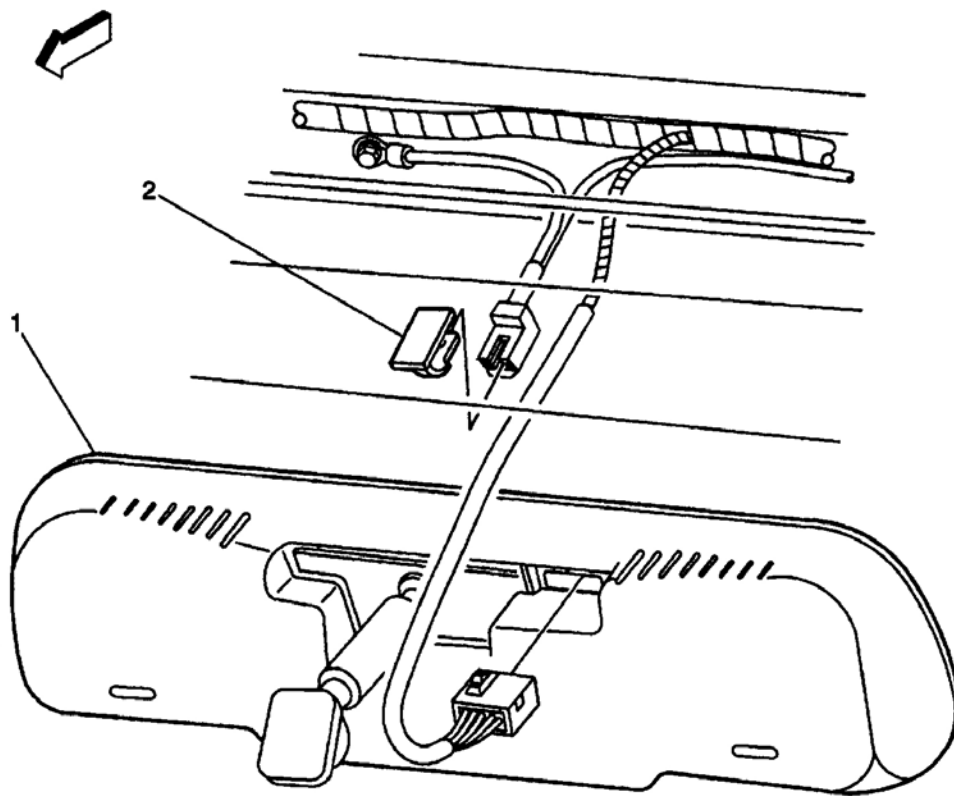

- (1) Inside Rearview Mirror
(2) Front Window Antenna (Coupe/Hardtop)

G00260627

Fig. 55: Inside Rear View Mirror
Courtesy of GENERAL MOTORS CORP.

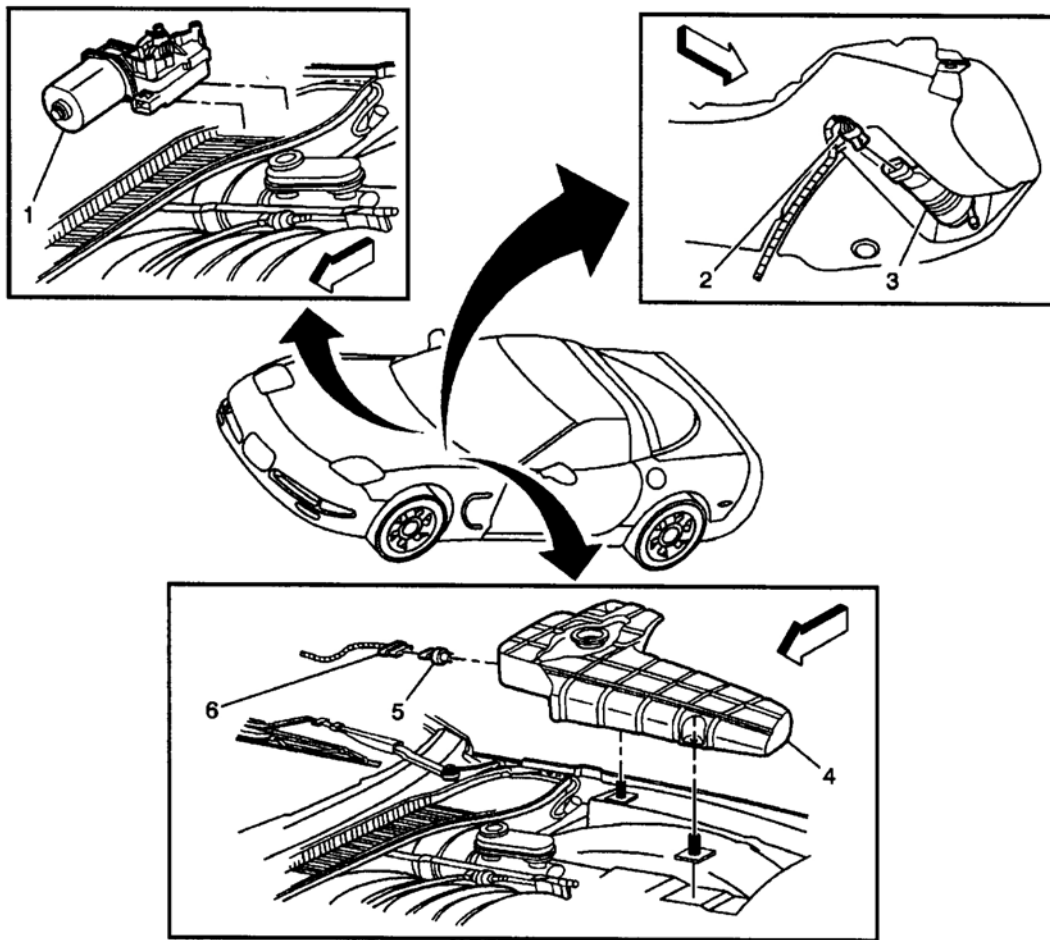

- (1) Windshield Wiper Motor
- (2) Windshield Washer Fluid Pump Connector
- (3) Windshield Washer Fluid Pump
- (4) Windshield Washer Fluid Reservoir
- (5) Windshield Washer Fluid Level Switch
- (6) Windshield Washer Fluid Level Switch Connector

G00260628

Fig. 56: Wiper/Washer System Overview
Courtesy of GENERAL MOTORS CORP.

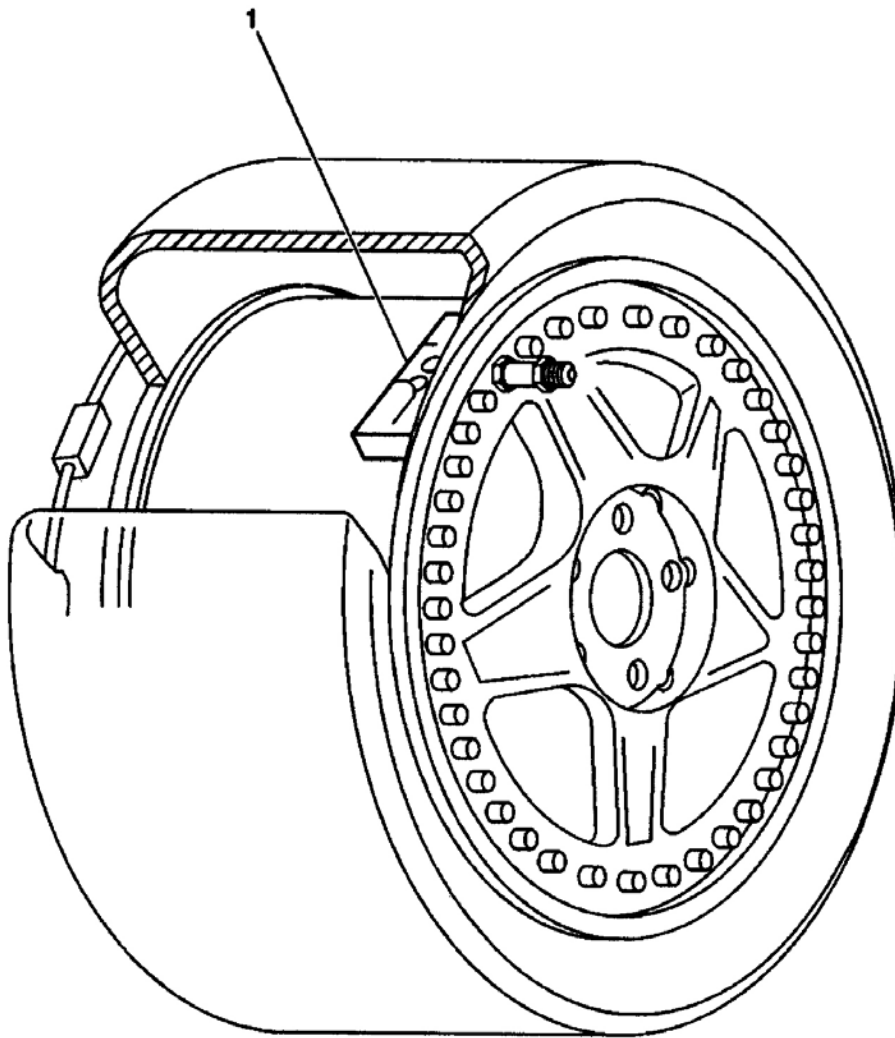

(1) Tire Pressure Monitor Sensor

G00260574

Fig. 57: Tire Pressure Monitor Sensor
Courtesy of GENERAL MOTORS CORP.

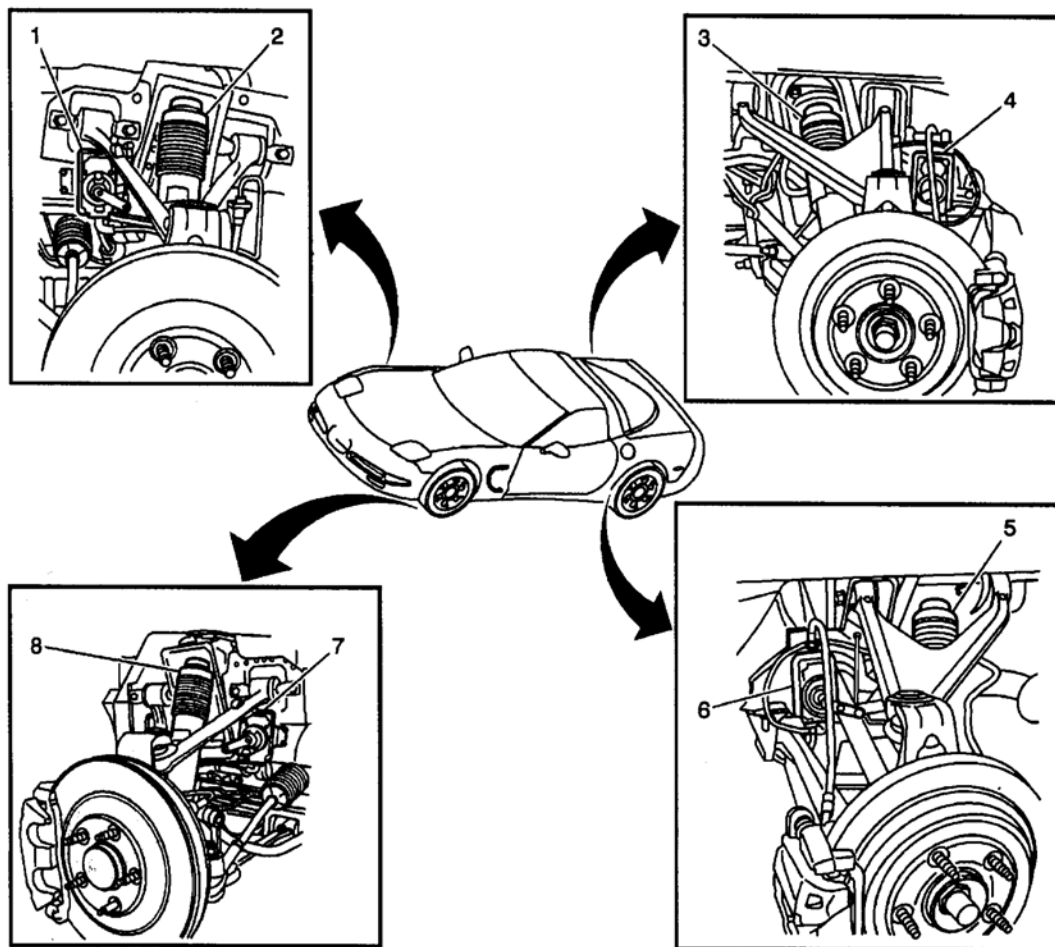

- (1) Suspension Position Sensor - RF
- (2) Suspension Damper - RF
- (3) Suspension Damper - RR
- (4) Suspension Position Sensor - RR
- (5) Suspension Damper - LR
- (6) Suspension Position Sensor - LR
- (7) Suspension Position Sensor - LF
- (8) Suspension Damper - LF

G00260576

Fig. 58: Suspension System Overview
Courtesy of GENERAL MOTORS CORP.

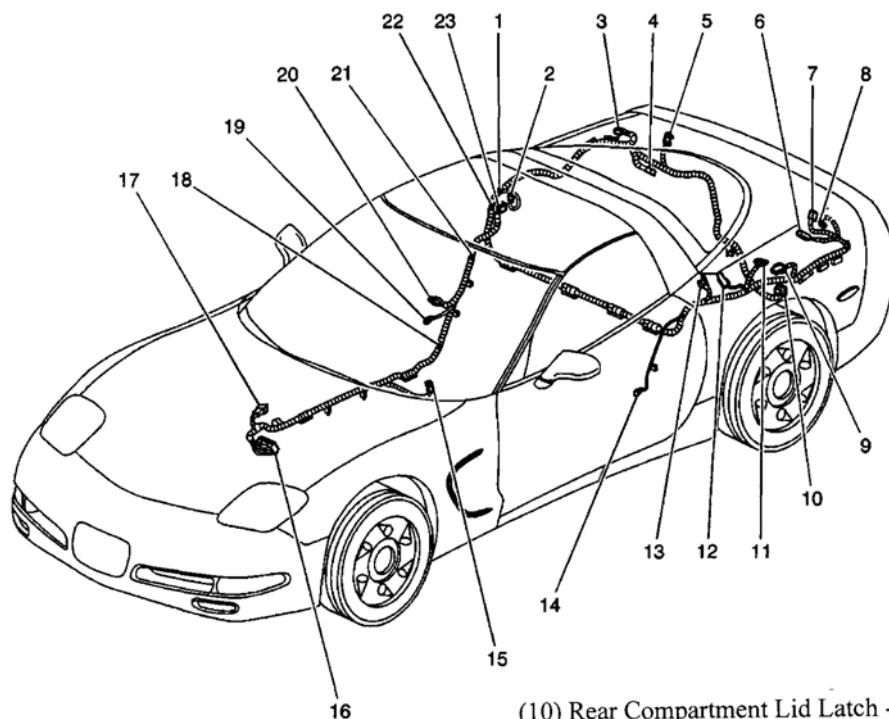

- (1) S304
- (2) Inline to Defogger Grid (Power)
- (3) Rear Compartment Courtesy Lamp - Right
- (4) Rear Compartment Lid Latch - Right C2
- (5) Remote Playback Device - CD Changer
- (6) Rear Compartment Courtesy Lamp - Left
- (7) Rear Compartment Lid Latch-Left C2
- (8) Rear Compartment Lid Latch-Left C1
- (9) Fuel Door Lock Actuator

- (10) Rear Compartment Lid Latch - Right C1
- (11) Remote Control Door Lock Receiver (RCDLR)
- (12) Inline to Defogger Grid (Ground)
- (13) Speaker - LR
- (14) G301
- (15) C302
- (16) Fuse Block - I/P C3
- (17) C204
- (18) S314 and S312
- (19) G302
- (20) SP302
- (21) S302
- (22) S303
- (23) Speaker - RR

G00262180

Fig. 59: Body Harness
Courtesy of GENERAL MOTORS CORP.

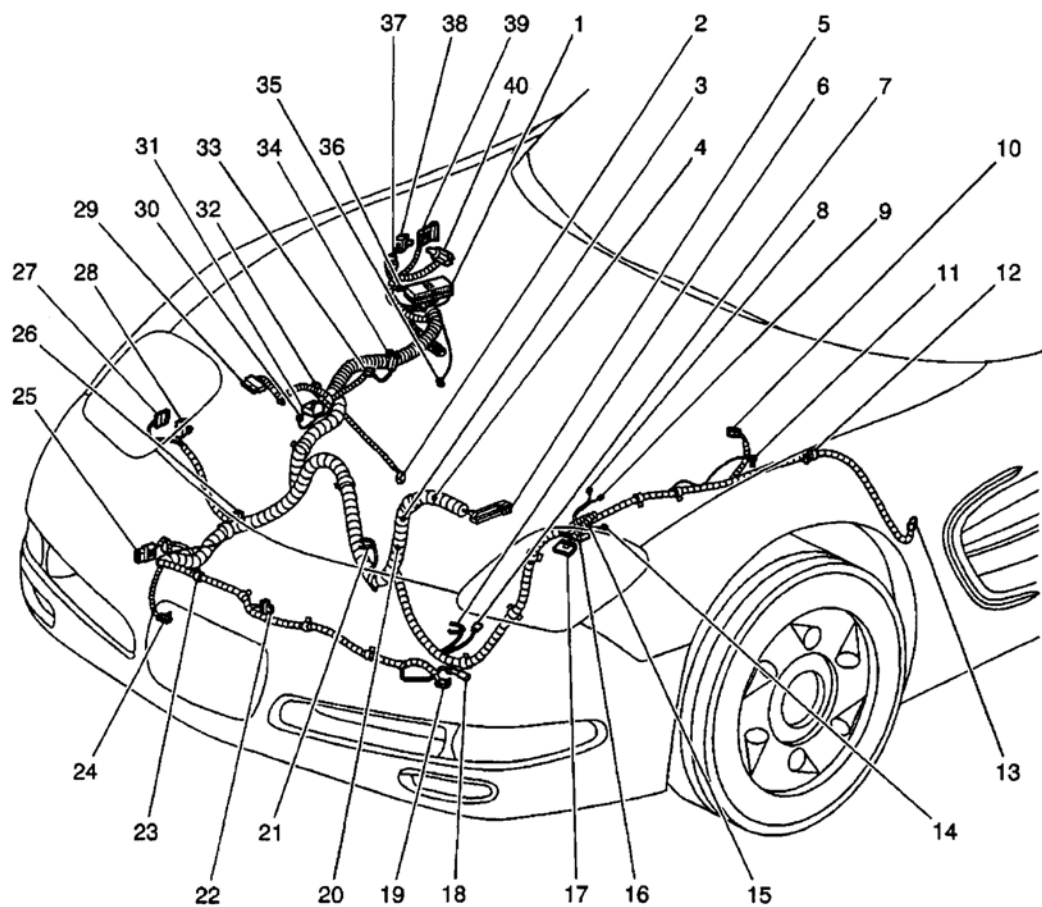

- (1) Fuse Block - Underhood C3
- (2) A/C Compressor Clutch
- (3) S106
- (4) S107
- (5) Electronic Brake Control Module (EBCM)
- (6) Cooling Fan - Left
- (7) C107
- (8) Brake Fluid Pressure Sensor
- (9) Brake Differential Switch

G00262181

Fig. 60: Forward Lamp Harness (1 Of 2)
Courtesy of GENERAL MOTORS CORP.

- (10) Brake Fluid Level Switch
- (11) Windshield Washer Fluid Pump
- (12) Repeater Lamp - Left
- (13) Windshield Washer Fluid Level Switch
- (14) G103
- (15) SP101
- (16) G101
- (17) Headlamp Door Assembly - Left
- (18) Fog Lamp - LF
- (19) Secondary Air Injection (AIR) Pump
- (20) S108
- (21) Cooling Fan - Right
- (22) Ambient Air Temperature Sensor
- (23) Fog Lamp - RF
- (24) Horn Assembly
- (25) C100
- (26) C113
- (27) Headlamp Door Control Module C2
- (28) Headlamp Door Control Module C1
- (29) Headlamp Door Assembly - Right
- (30) G102
- (31) SP100
- (32) Secondary Air Injection (AIR) Solenoid
- (33) A/C Refrigerant Pressure Sensor
- (34) Repeater Lamp - Right
- (35) G108
- (36) C102
- (37) UHEC C6
- (38) C148
- (39) C140
- (40) C150

G00262182

Fig. 61: Forward Lamp Harness (2 Of 2)
Courtesy of GENERAL MOTORS CORP.

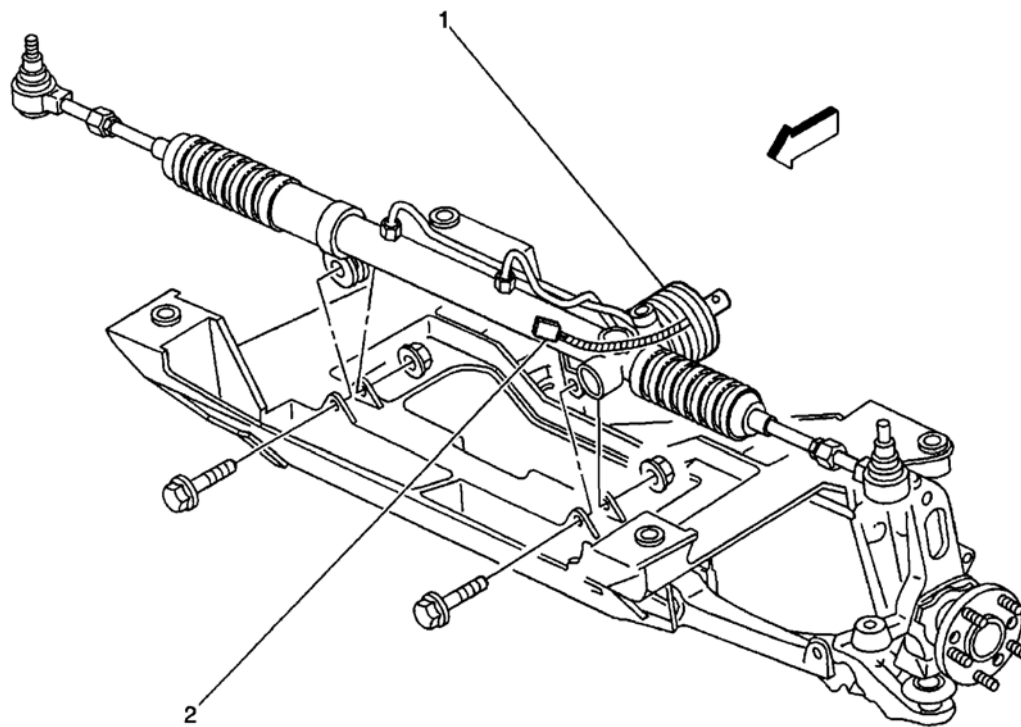

- (1) Variable Effort Steering Actuator
(2) Variable Effort Steering Actuator Connector

G00262207

Fig. 62: Lower Front Of Vehicle
Courtesy of GENERAL MOTORS CORP.